

## Standing School Desk K-5

vari®



Holds up to  
300 lb (136 kg)



2 People Required

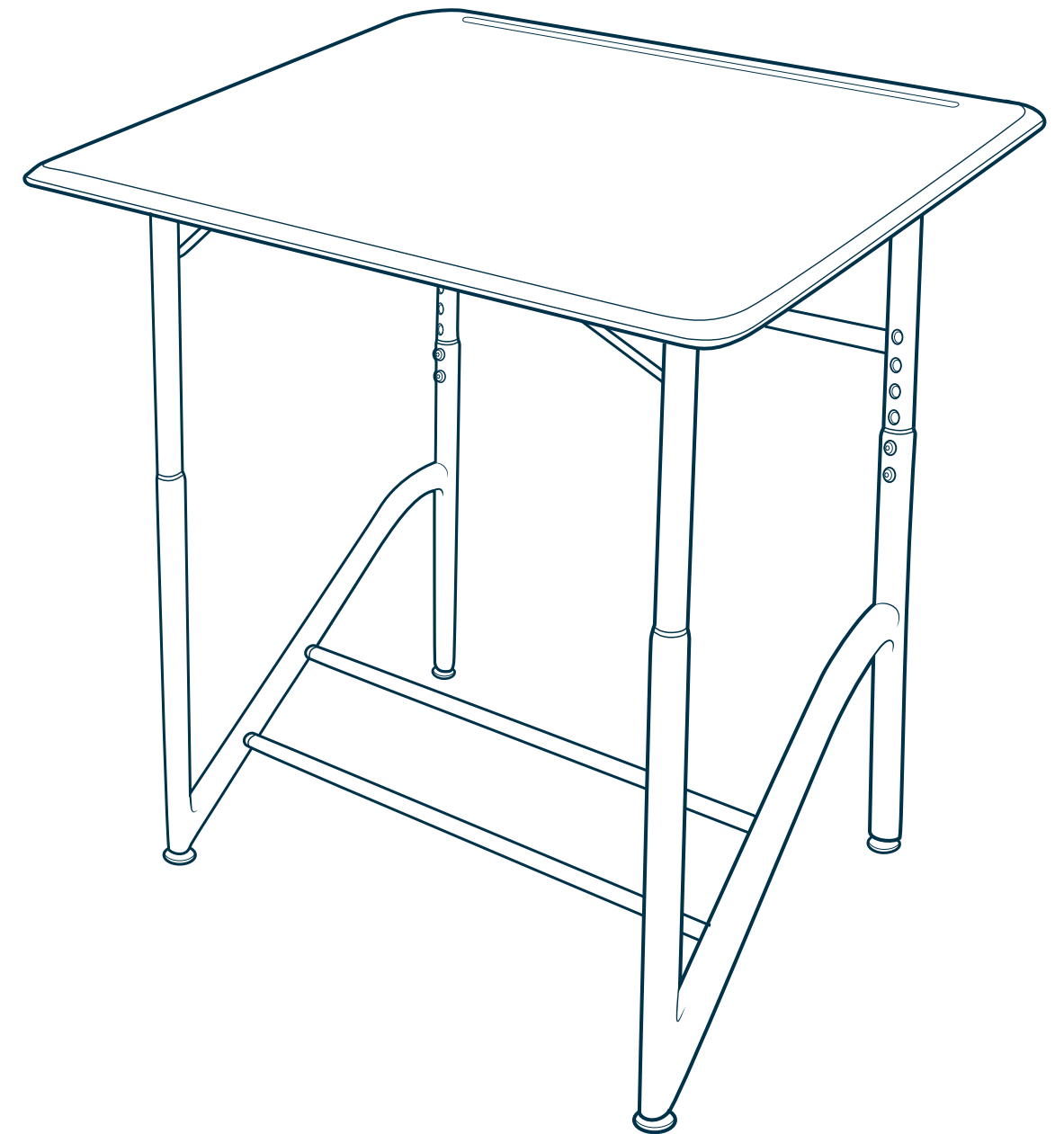

**(800) 207-2587**

vari®

1

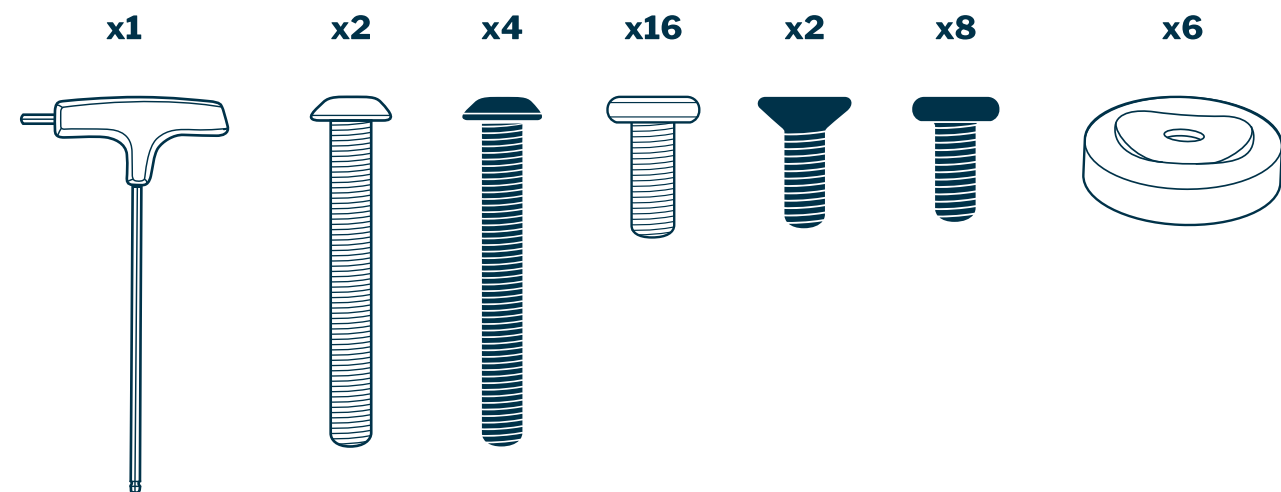
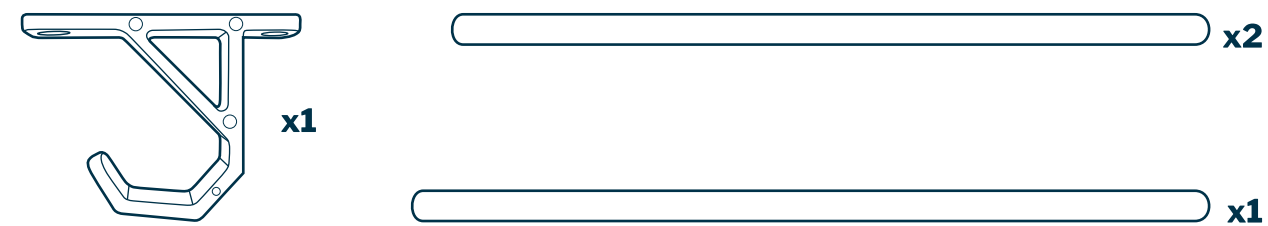
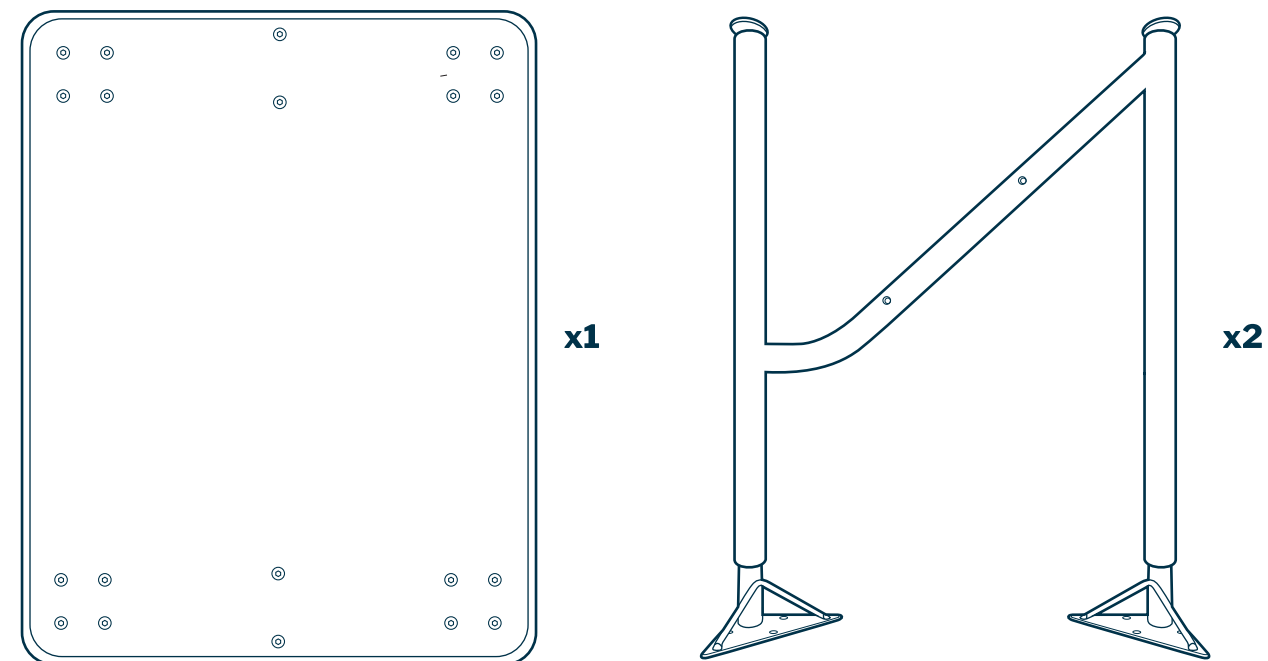

Remove everything from the box except for the desktop, placing the hardware bag of tools and bolts in an accessible area. Remove the legs from their plastic wrap.

9

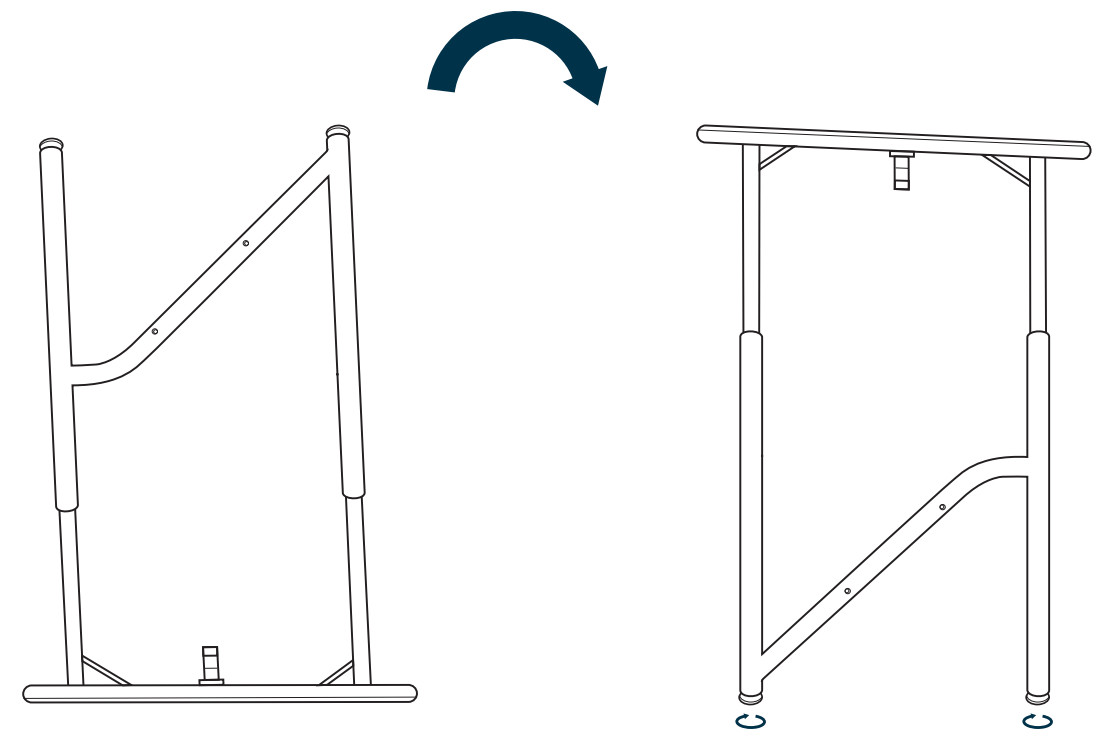

Turn the desk upright and adjust the foot levelers as needed.

10

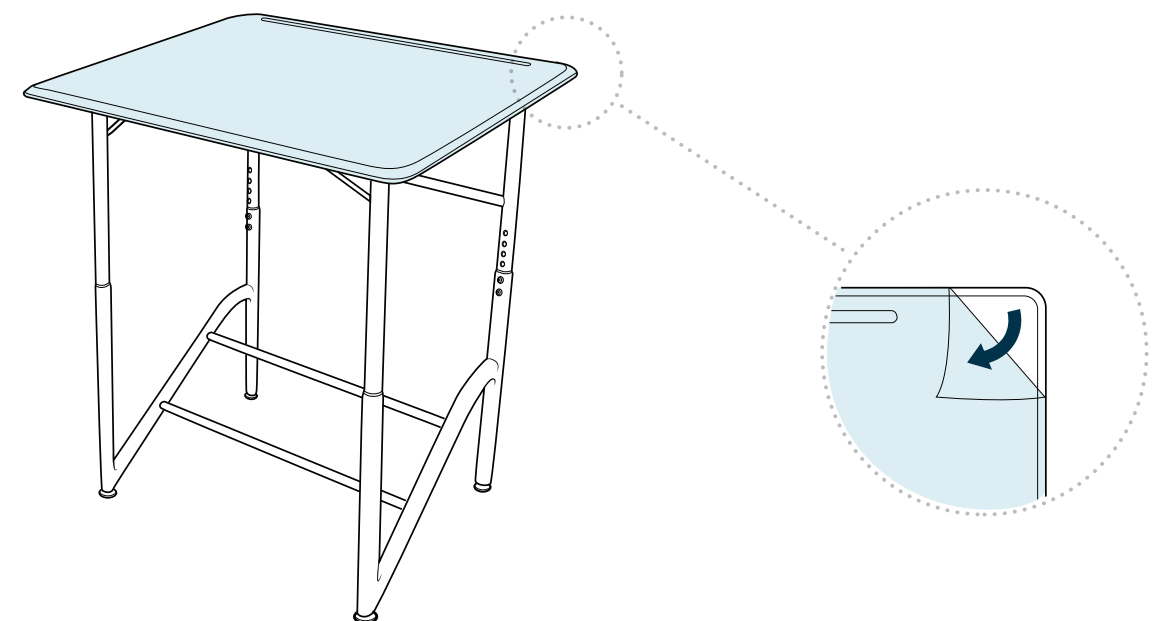

Remove the protective plastic covering from the desktop before use.

7

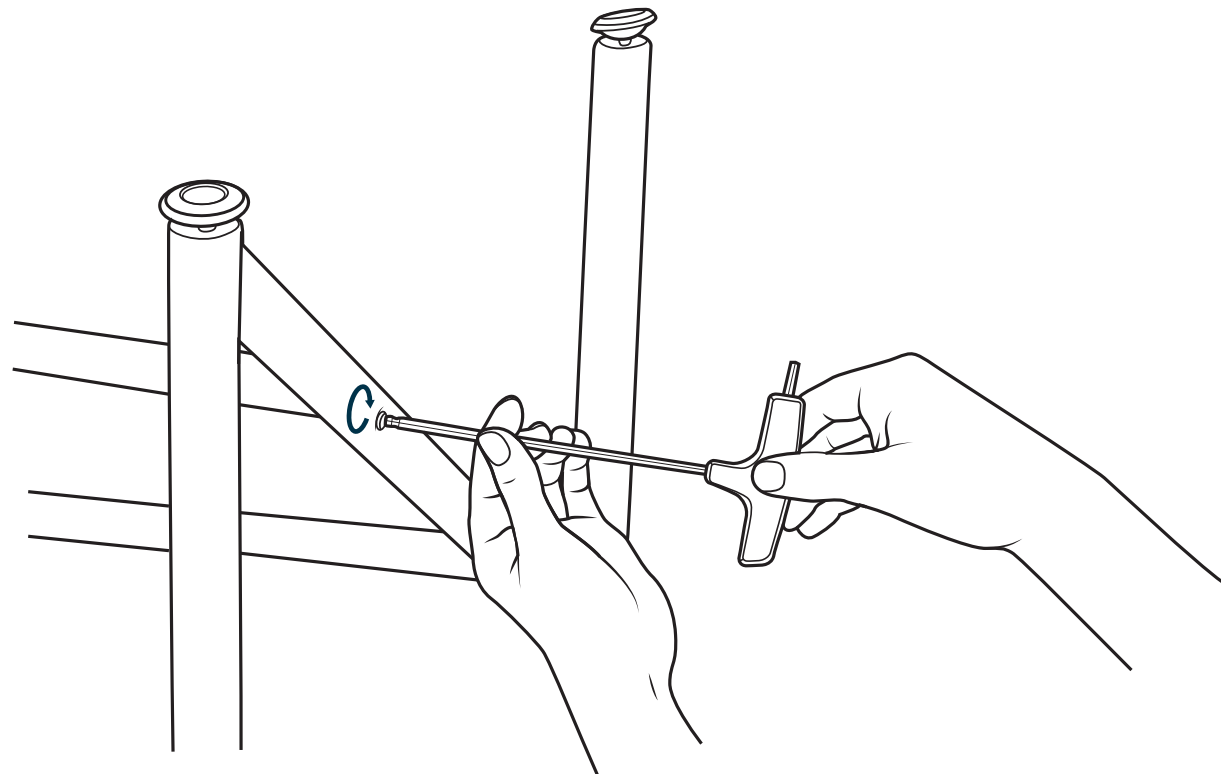

Go back over each bolt connection to tightly fasten, using the Allen key tool to secure.

8

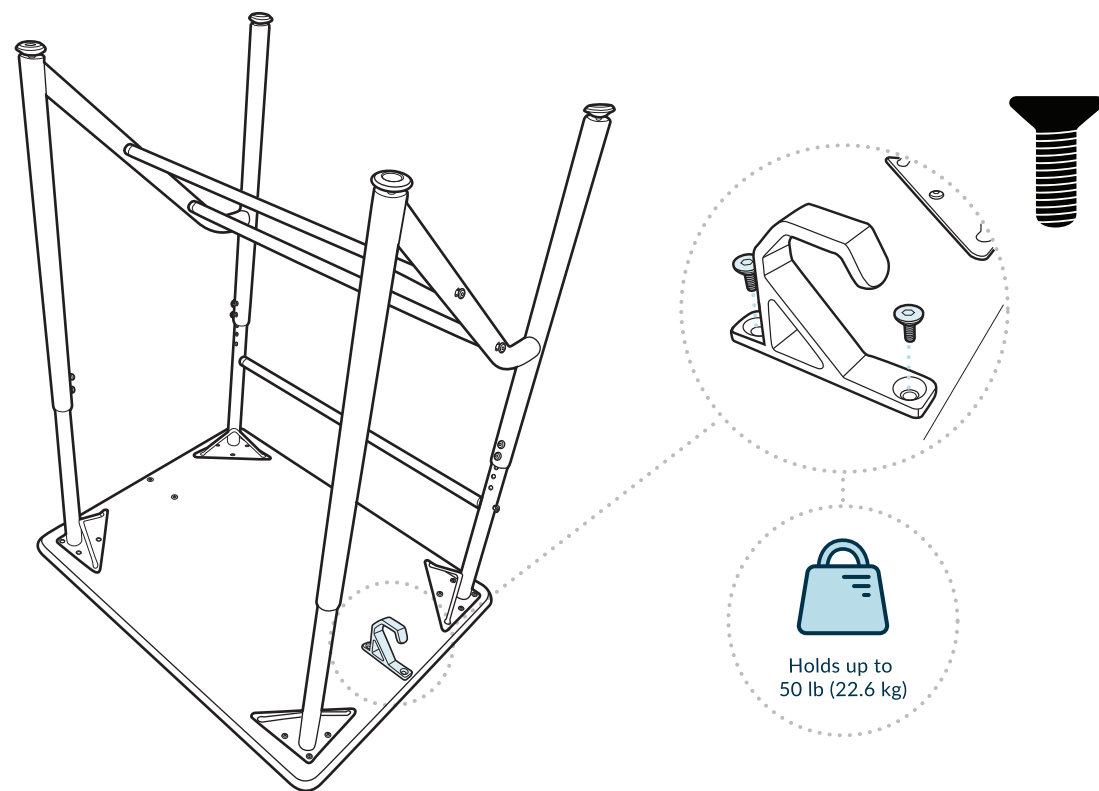

Holds up to  
50 lb (22.6 kg)

Install the bag hook on either side of the desk by lining it up over the holes on one side of the desk between the legs and securely attaching with the 2 bolts pictured.

2

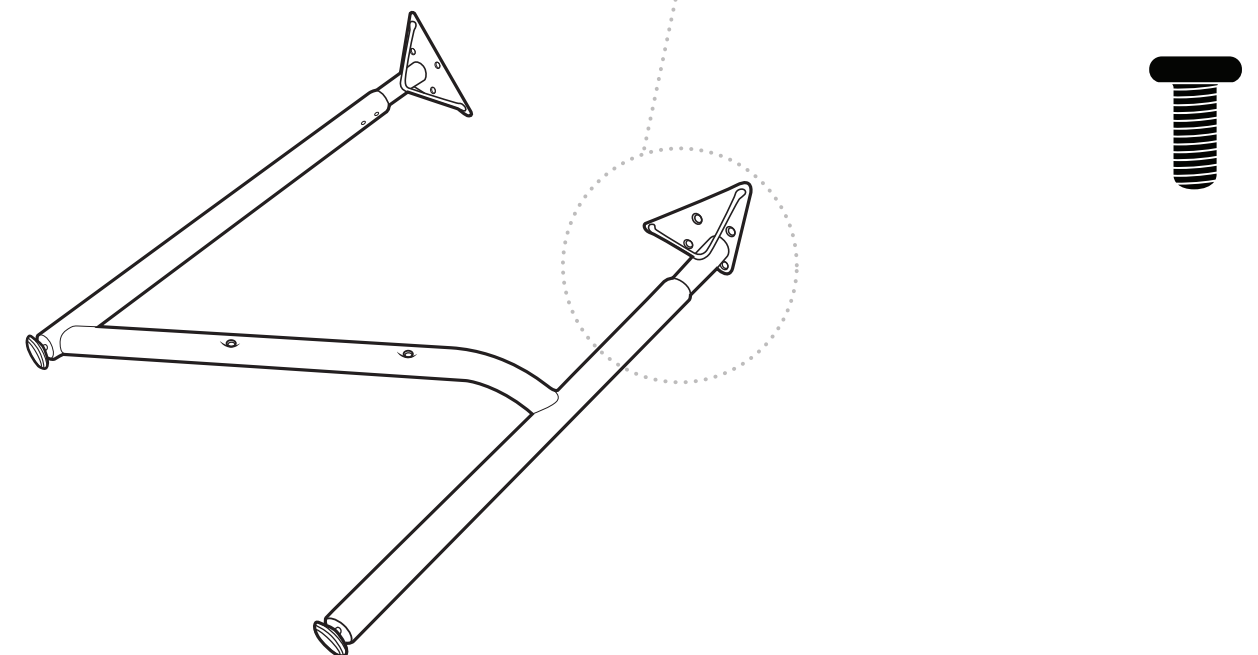
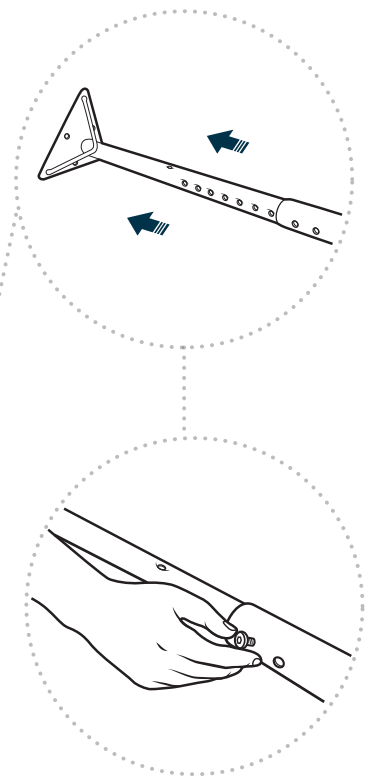
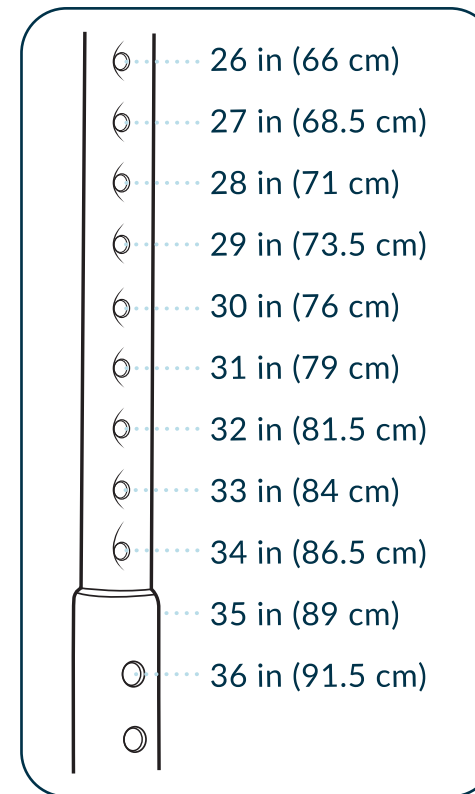

Pulling the tube through the metal leg, decide the height of the legs by aligning the holes and placing 2 of the pictured bolts into the holes without fully tightening. The legs can be adjusted to any height between 26" and 36" in 1" increments.

3

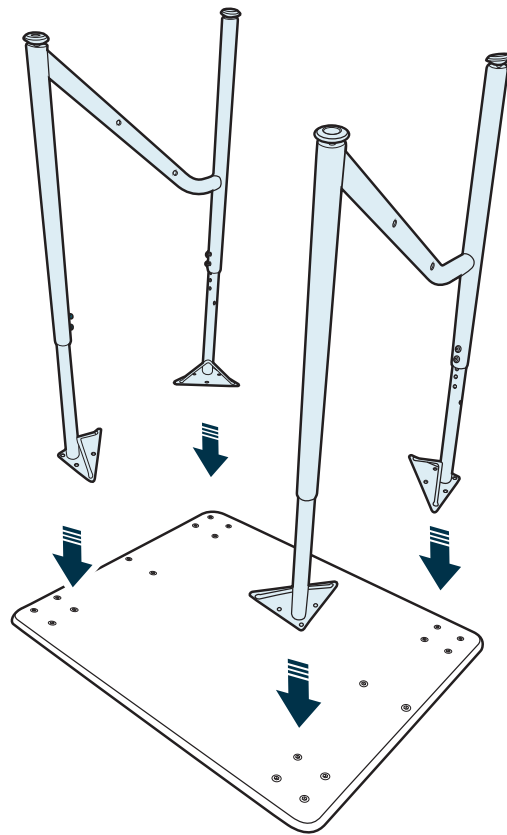

The desk leg brackets are marked with numbers 1 – 4. With the desk face side down, line up each leg with the corresponding number markers on the desktop corners.

4

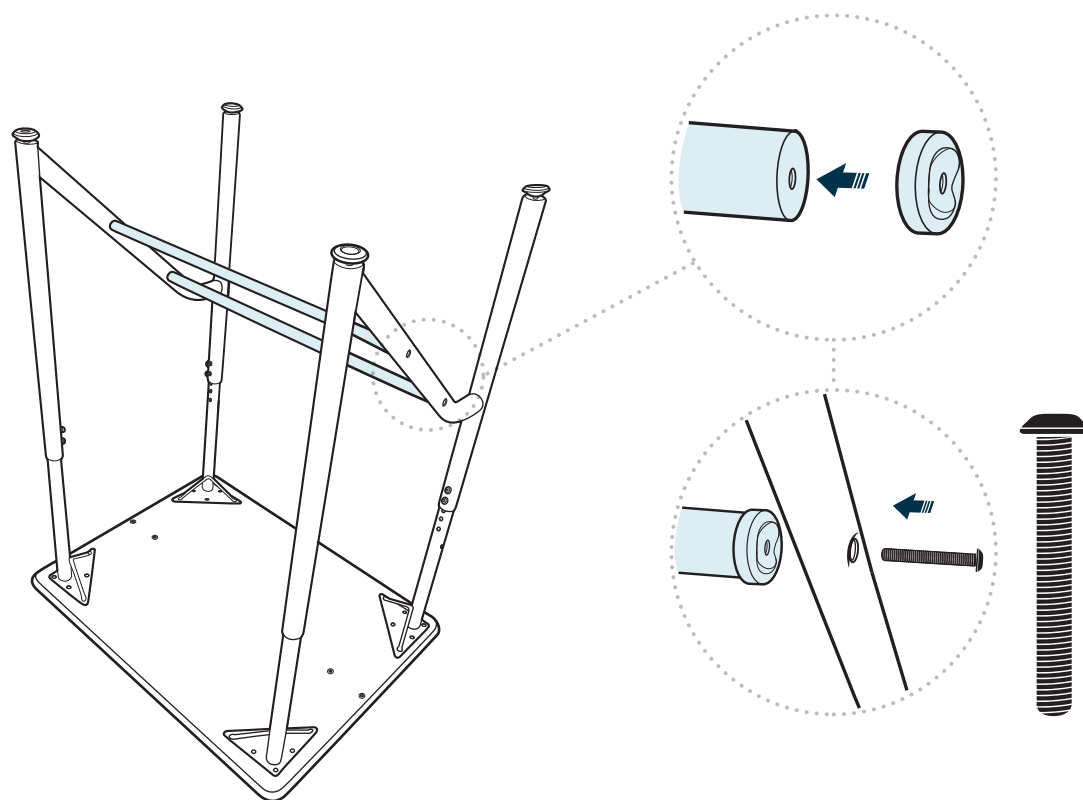

Take the 2 bars that are approx. 4 mm shorter, add the pictured metal caps to each end of the bars, then line up with the leg holes. Attach the pictured bolts without fully tightening.

5

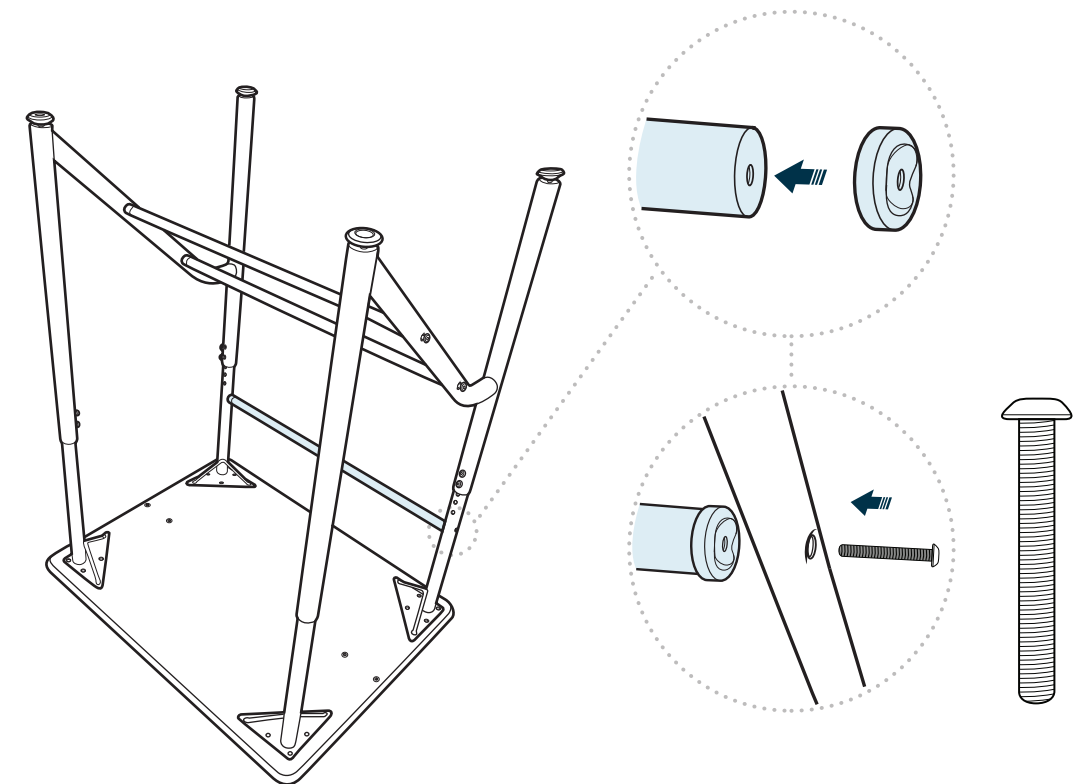

Add metal caps to the third, slightly longer bar and align with the holes towards the back of the desk. Attach the pictured bolts without fully tightening.

6

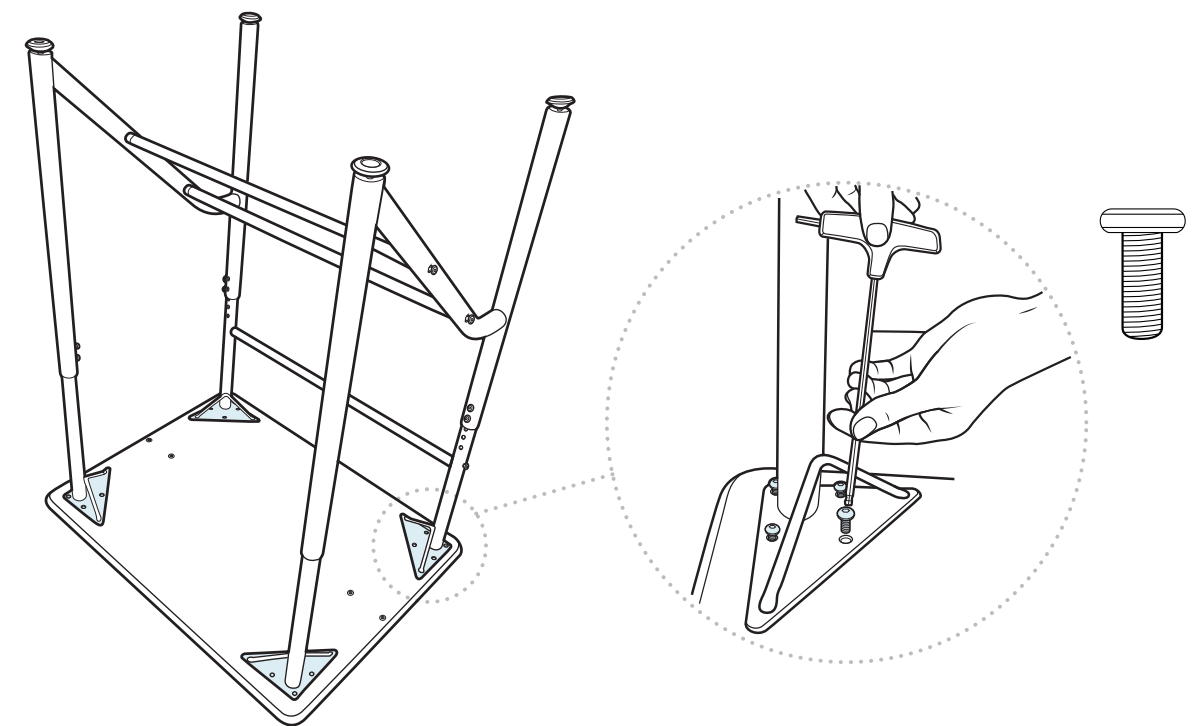

Now that the footrests and crossbar have been connected to the legs, fasten the 4 pictured bolts into the brackets.