

Remove the protective plastic covering from the desktop before use.



(800) 207-2587

vari[®]

Standing School Desk for Two K-5

vari[®]



1

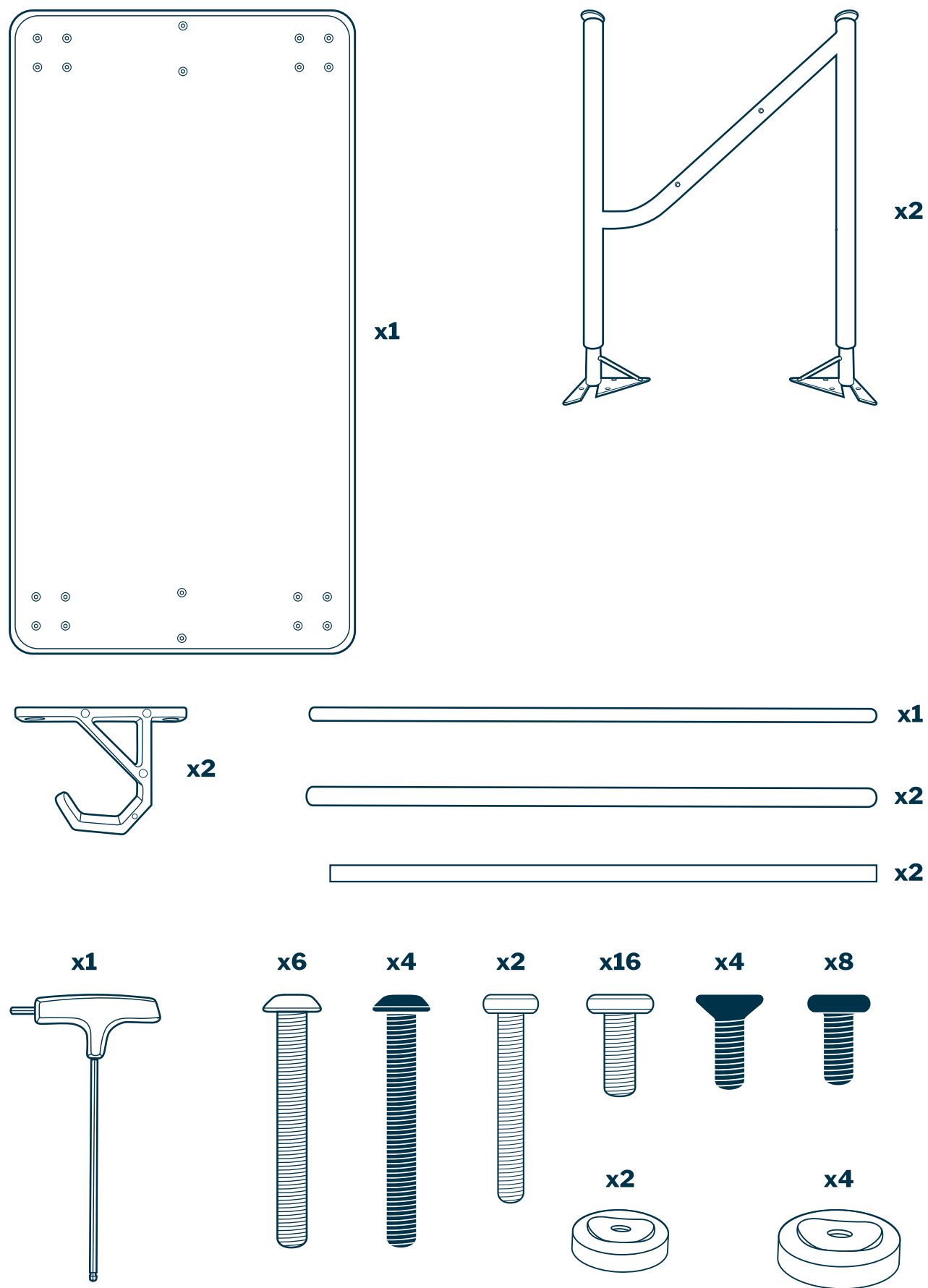

Remove everything from the box except for the desktop, placing the hardware bag of tools and bolts in an accessible area. Remove the legs from their plastic wrap.

9

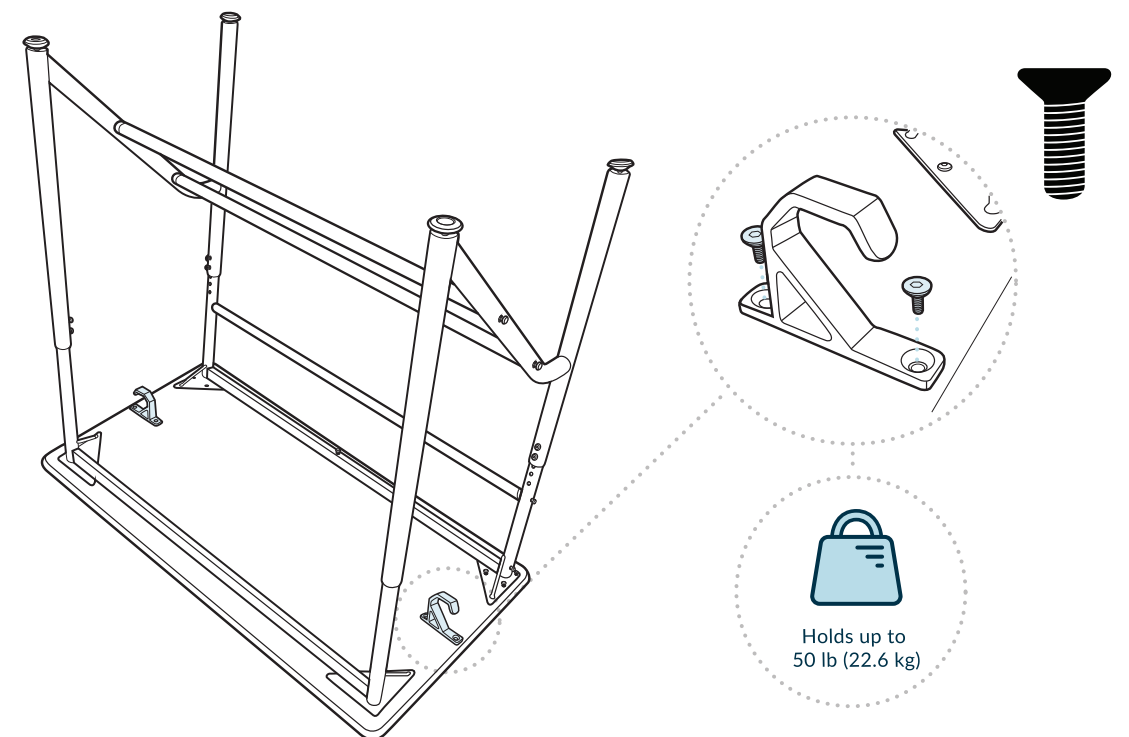

To install the bag hooks, line them up over the holes on each side of the desk between the legs and securely bolt them into place with the bolts pictured.

10

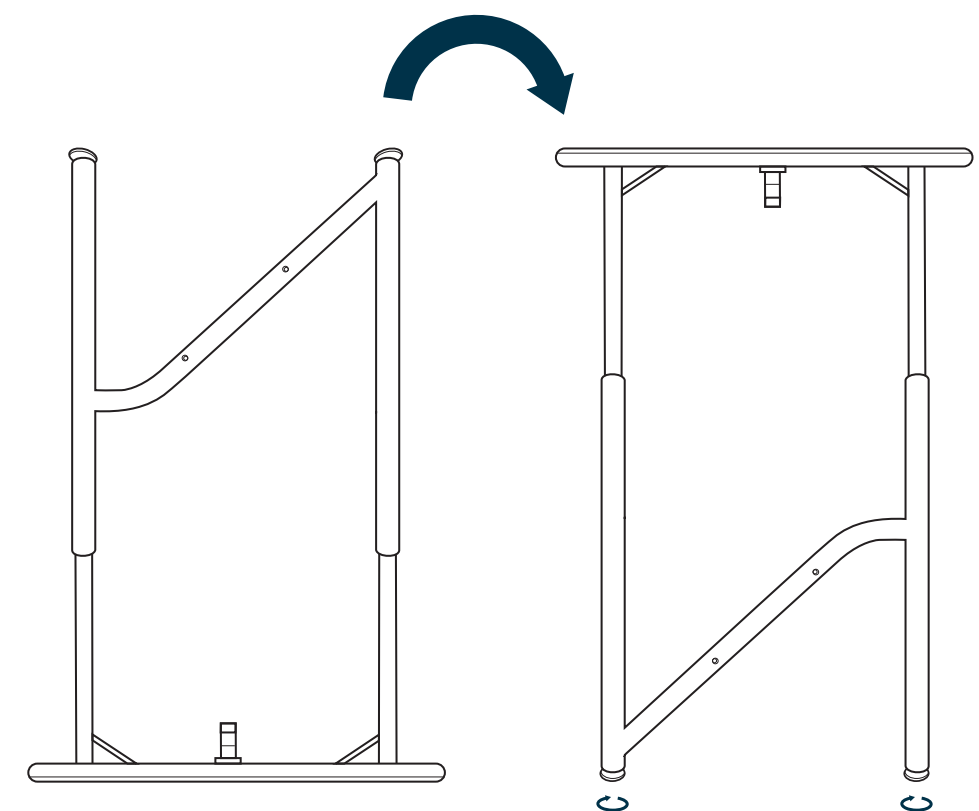

Turn the desk upright and adjust the foot levelers as needed.

7

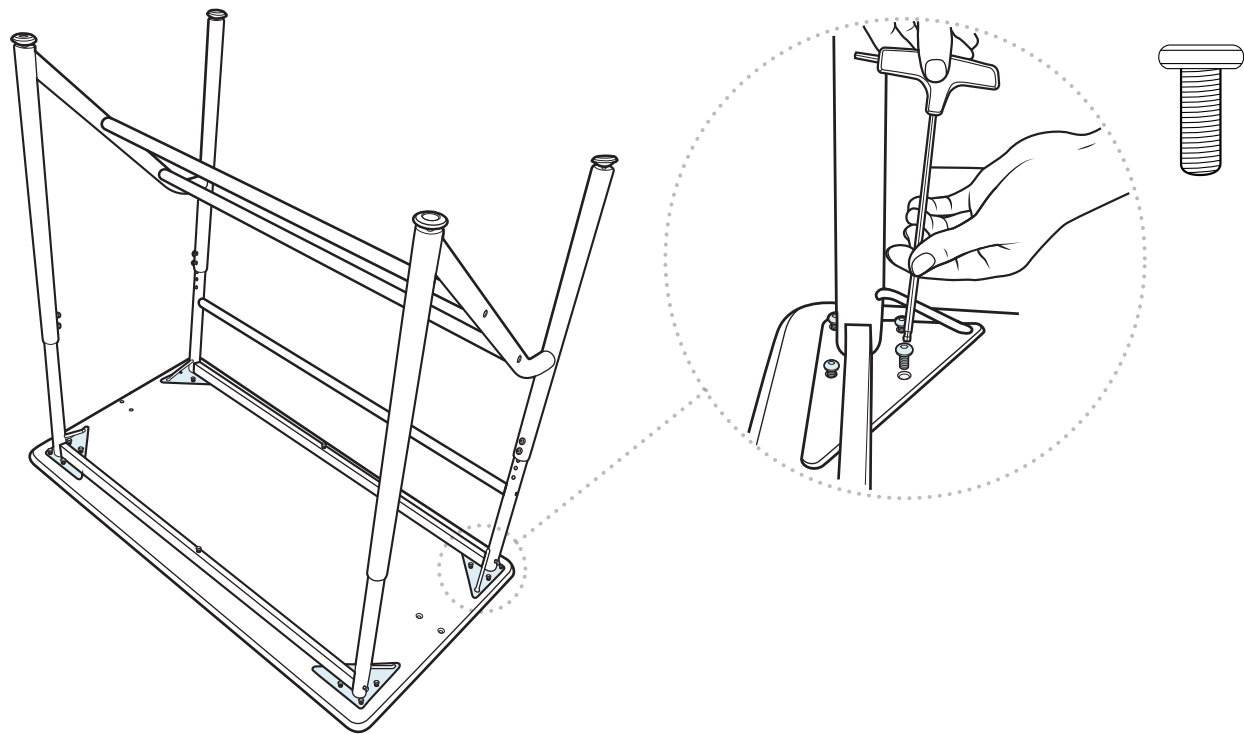

Now that the footrests and crossbar have been connected to the legs, you can fully tighten bolts into their brackets, using the Allen key to secure each bolt.

8

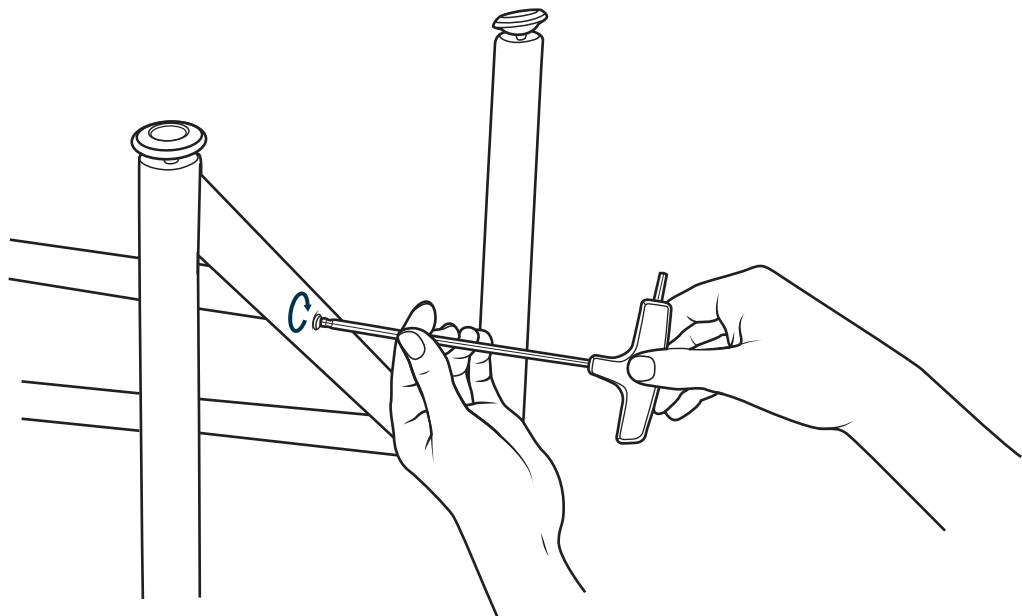

Go over each bolt connection and fully tighten using the Allen key to secure.

2

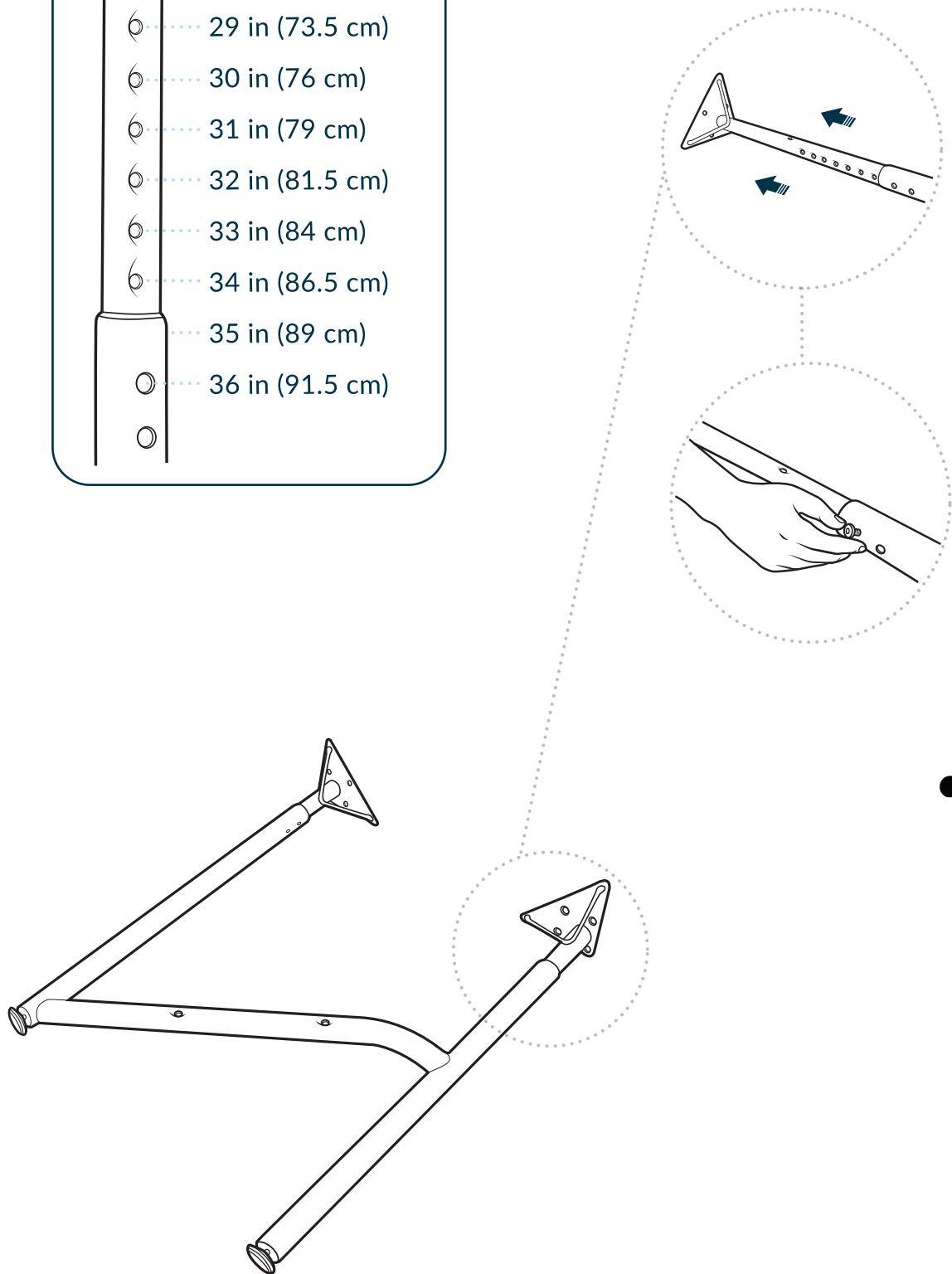
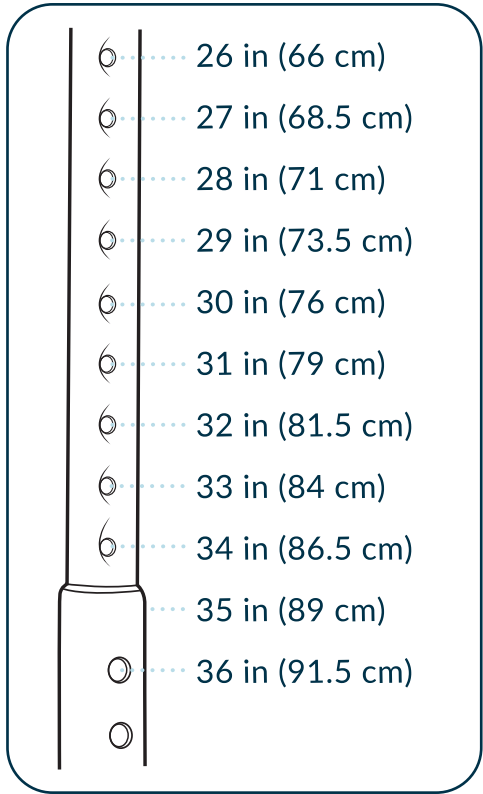

Pulling the tube through the metal leg, decide the height of the legs by aligning the holes and placing 2 of the pictured bolts into the holes without fully tightening. The legs can be adjusted to any height between 26" and 36" in 1" increments.

3

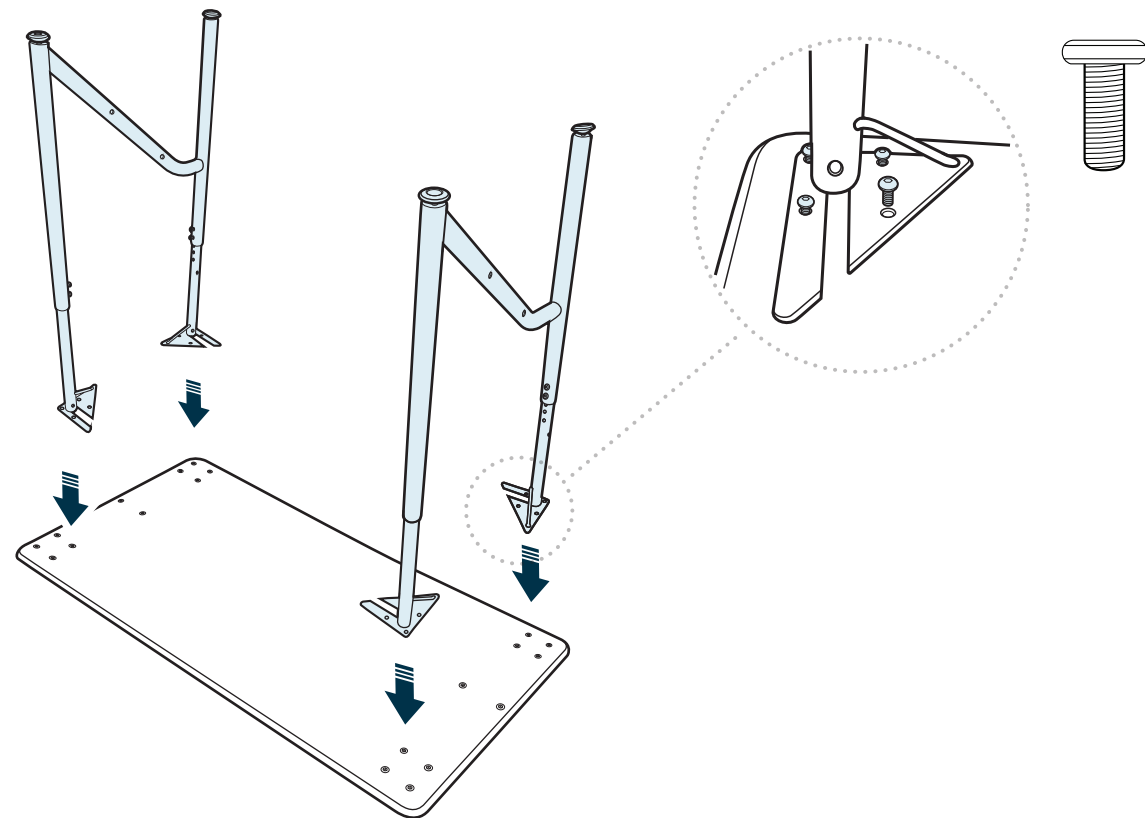

The desk leg brackets are marked with numbers 1 – 4. With the desk face side down, line up each leg with the corresponding number markers on the desktop corners. Attach the pictured bolts into the brackets without fully tightening.

4

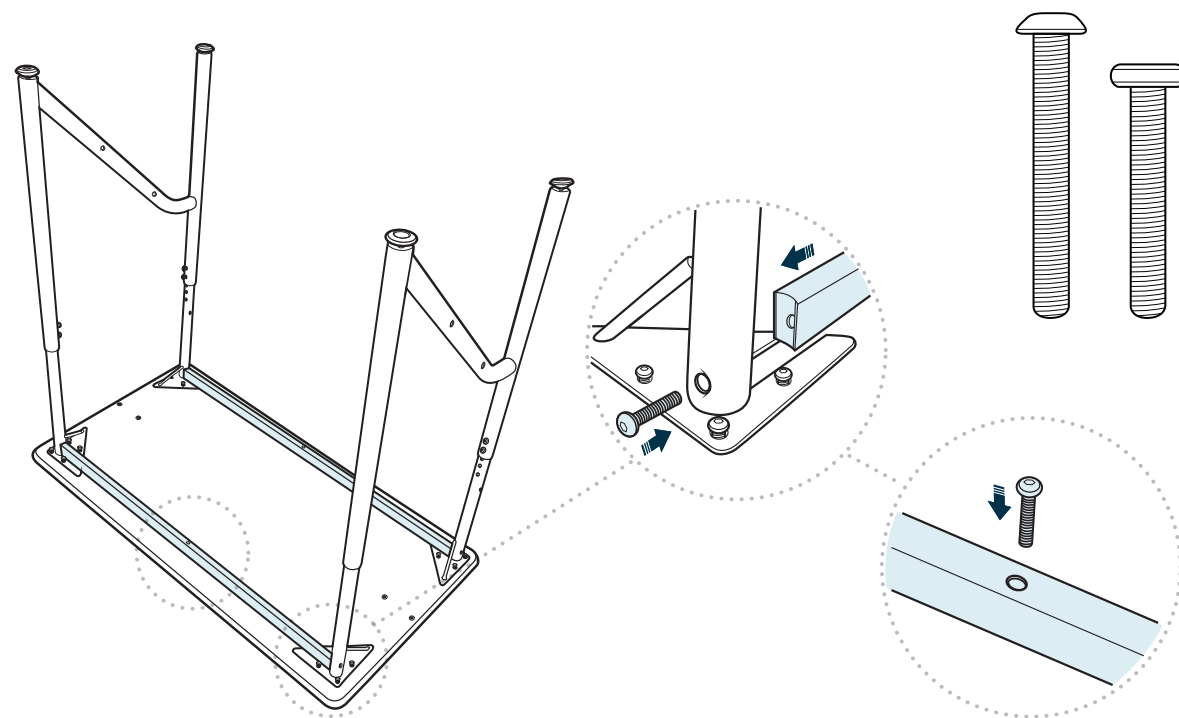

Place the long rectangular support bars in the bracket cutout. Attach the larger pictured bolts. Add the smaller pictured bolt into the middle of the support bar and fasten into the desk.

5

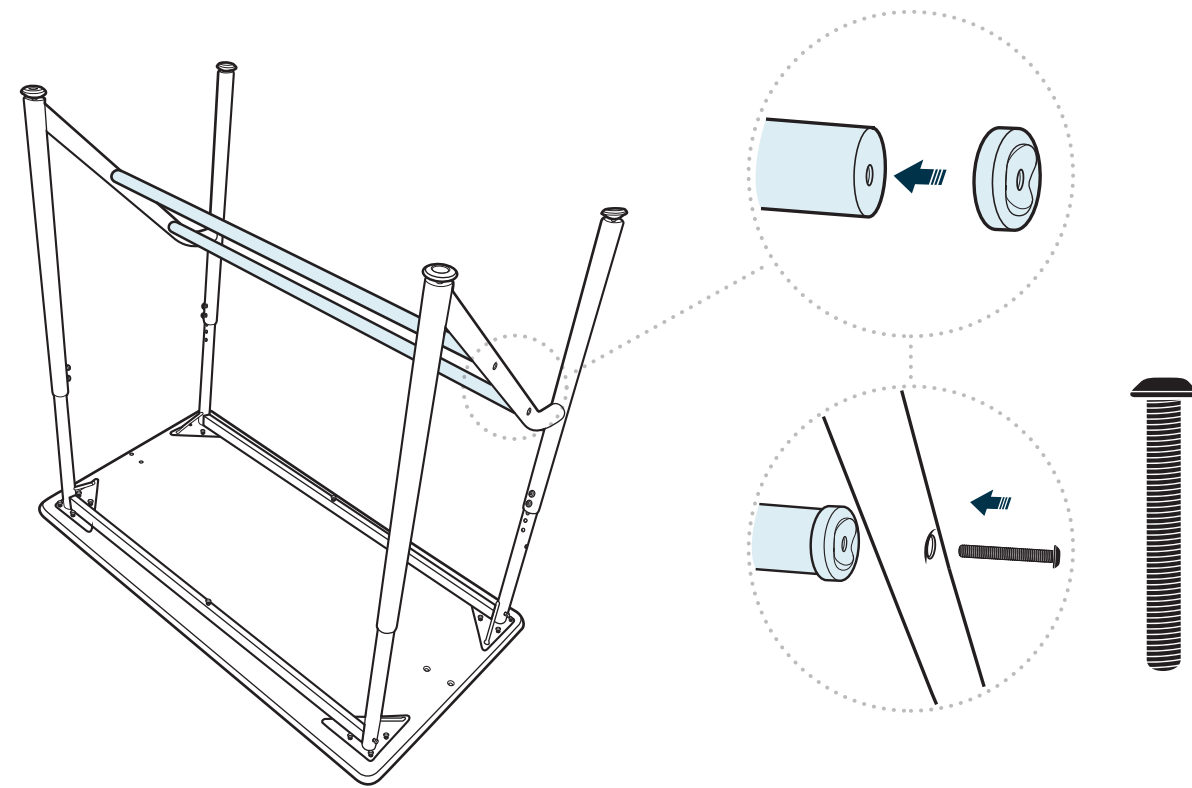

To install the 2 footrest bars, add the larger metal caps to each end of the bars, then line up with the leg holes. Attach the pictured bolts without fully tightening.

6

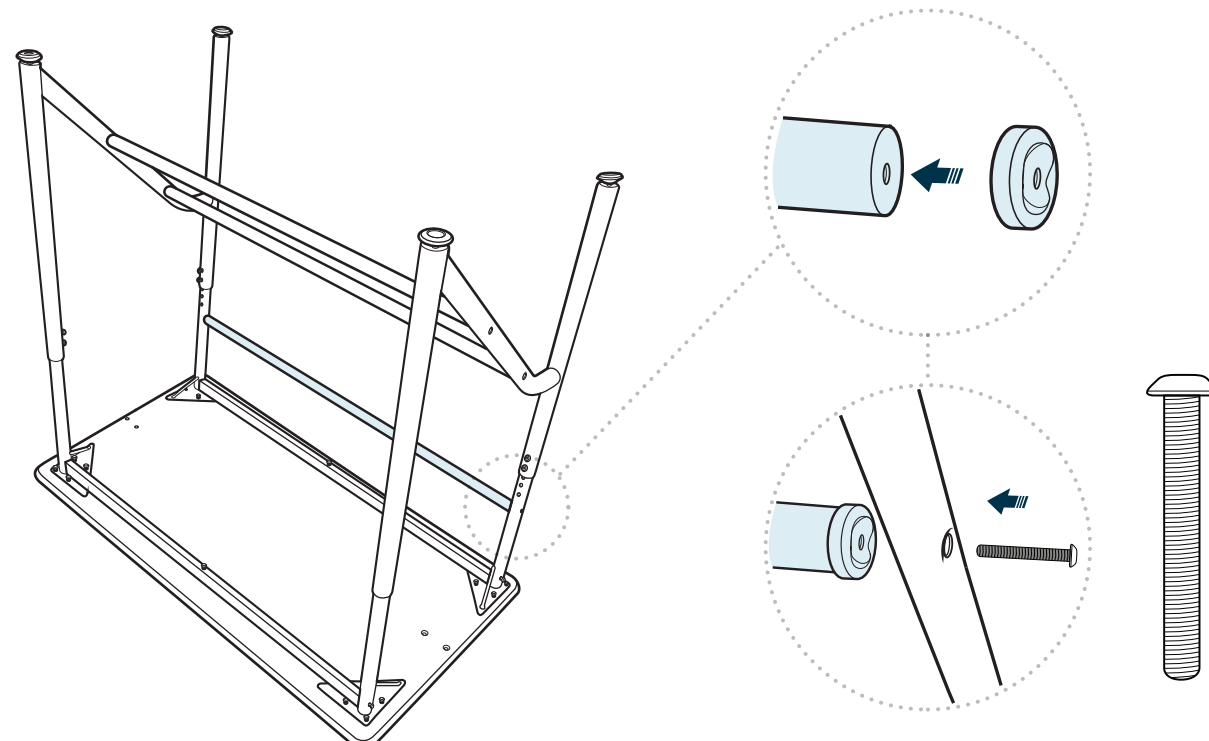

Add the smaller metal caps to the thinner crossbar and align with the holes towards the back of the desk. Attach the pictured bolts without fully tightening.