



2 People
Recommended



Holds up to
250 lb (113.4 kg)



Components



x1
CHAIR BACK

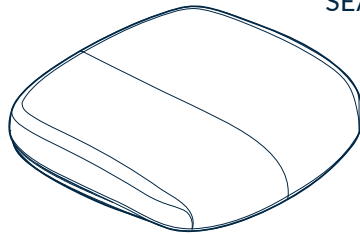

x1
SEAT PAN

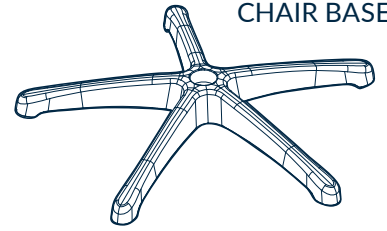

x1
CHAIR BASE

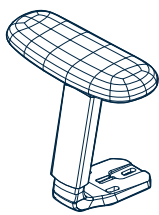

x1
RIGHT ARMREST

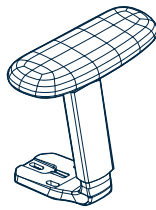

x1
LEFT ARMREST



x1
PISTON
Remove cap prior to assembly



x5
CASTERS



x4
M8 X 25MM
SCREWS



x5
M8 X 20MM
SCREWS

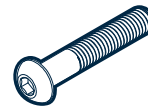

x6
M6 X 35MM
SCREWS

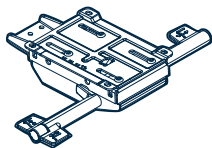

x1
MECHANISM
Comes pre-installed on seat pan

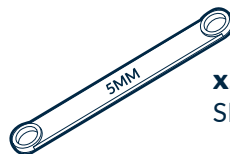

x2
SPACER

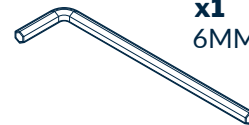

x1
6MM ALLEN KEY

1

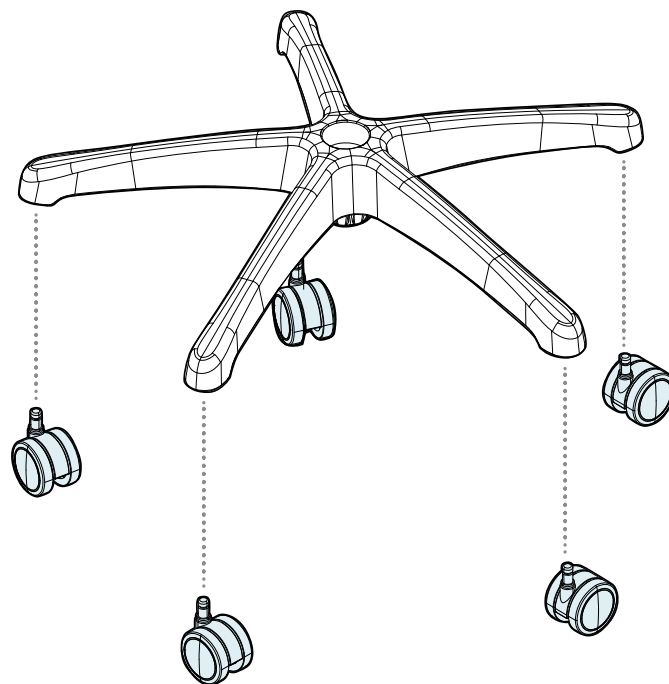

Insert the five **CASTERS** into the **CHAIR BASE** until they snap into place. Once attached, flip the base over.

2

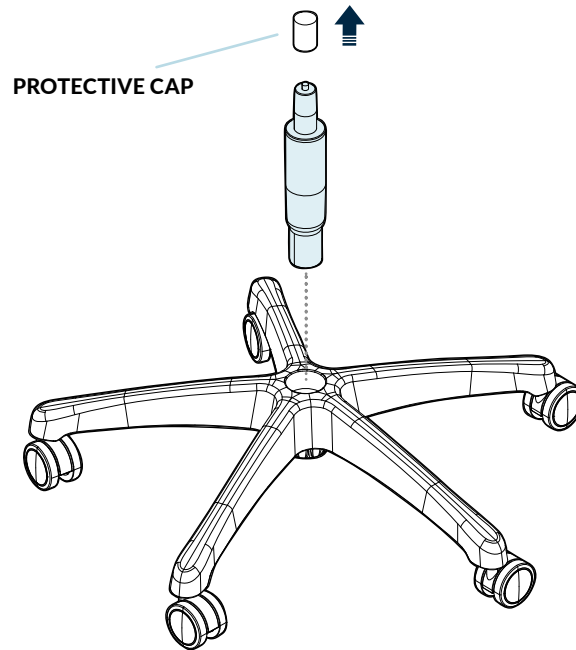

NOTE: Remove the **PROTECTIVE CAP** from the smaller end of the **PISTON**. Once the chair is assembled, the cap is no longer needed and can be discarded.

After removing the **CAP**, lower the larger end of the **PISTON** into the center of the base until it is secure.

3

M6 X 35MM SCREWS

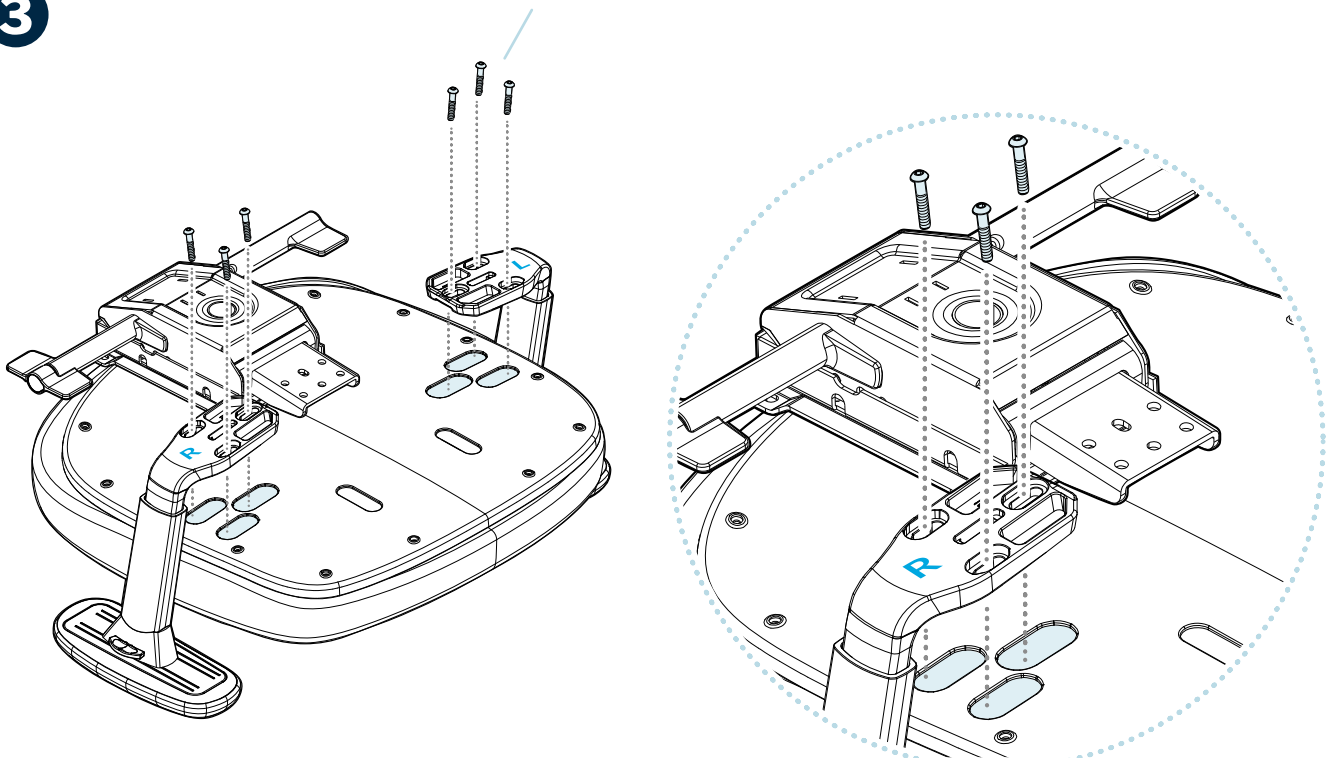

With the **SEAT PAN** upside down, align the **ARMREST** holes with the seat pan, ensuring the **L** and **R** marks match. Place **SIX (6) M6 X 35MM SCREWS** into the mounting holes of the **ARMRESTS** and tighten them securely using the included **6MM ALLEN KEY**.

4

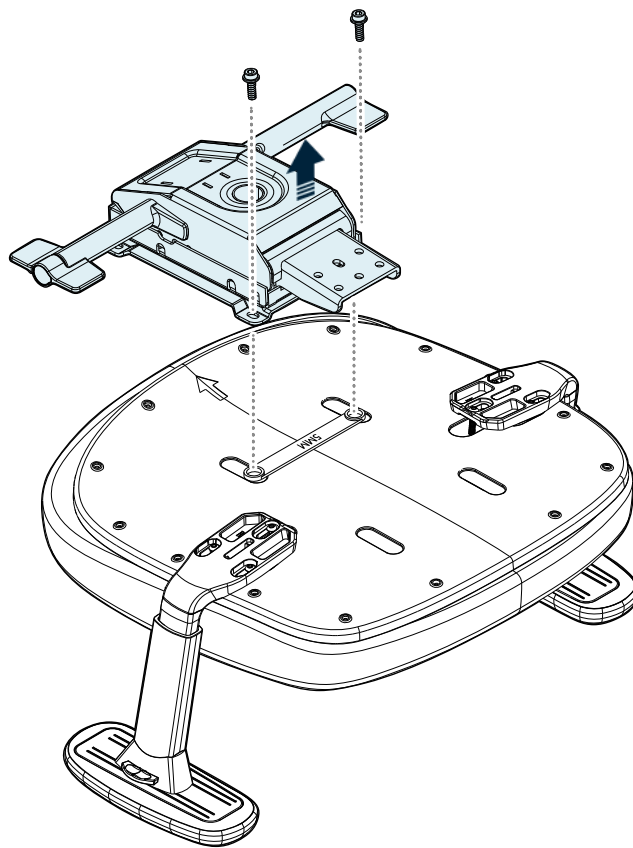

Using the included **6MM ALLEN KEY**, remove the pre-installed **MECHANISM** from the **SEAT PAN**.

5

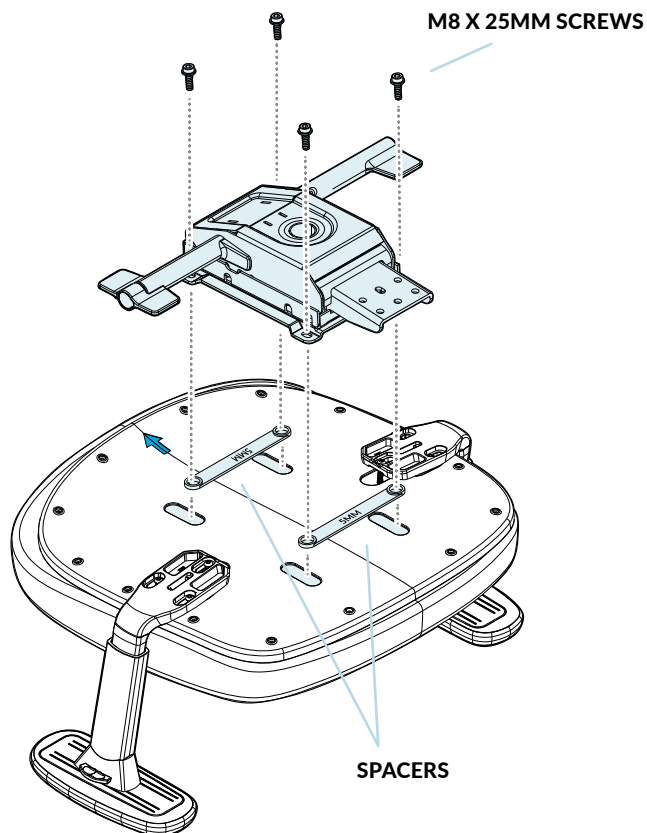

NOTE: Make sure the levers on the mechanism are positioned closest to the front of the seat pan.

Align the holes of the **SPACERS** with the mounting holes on the **SEAT PAN**, and then align the holes of the **MECHANISM** with the holes on the **SPACERS**. Insert **FOUR (4) M8 X 25MM SCREWS** into the mounting holes of the **MECHANISM**, and tighten them securely using the included **6MM ALLEN KEY**.

6

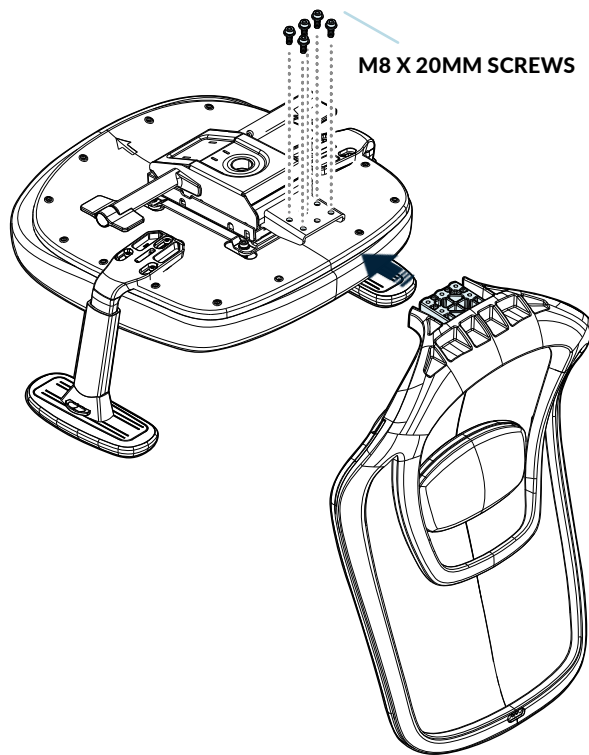

Secure the **CHAIR BACK** to the **SEAT PAN** by inserting **five (5) M8 X 20MM SCREWS** into the mounting holes shown. Tighten the screw sets securely using the included **6MM ALLEN KEY**.

7

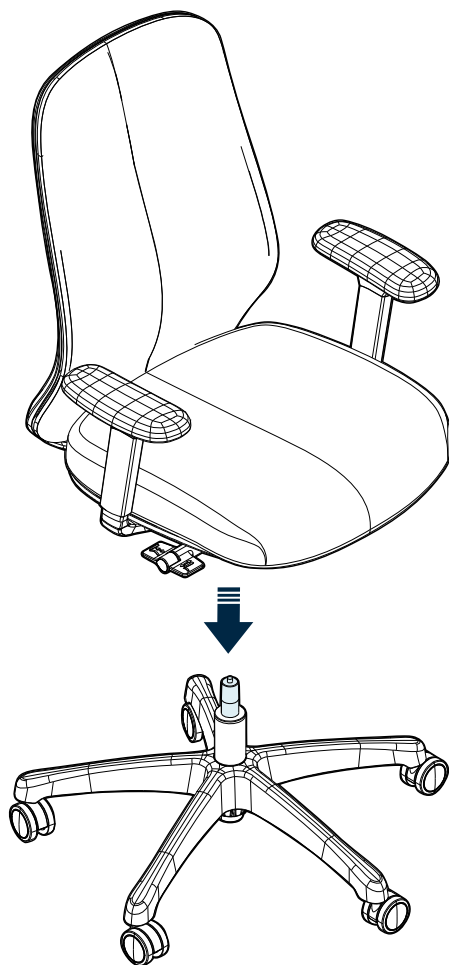

With assistance, carefully lower the chair seat onto the **PISTON**. Press down evenly on the seat cushion a few times to ensure it's fully secured.

CAUTION: Once assembled, do not attempt to disassemble the chair, as doing so could damage the product.

Adjustment Options

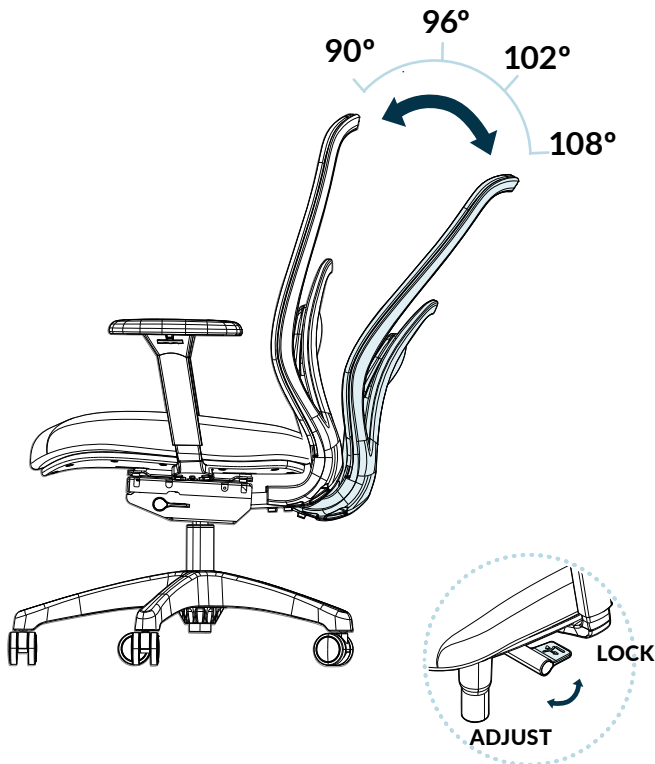

CHAIR BACK RECLINE LOCK & UNLOCK

To unlock and recline the chair back, push down the lever on the left side. There are (4) lockable angles – once you've reached your desired angle, release the lever to lock it in place.

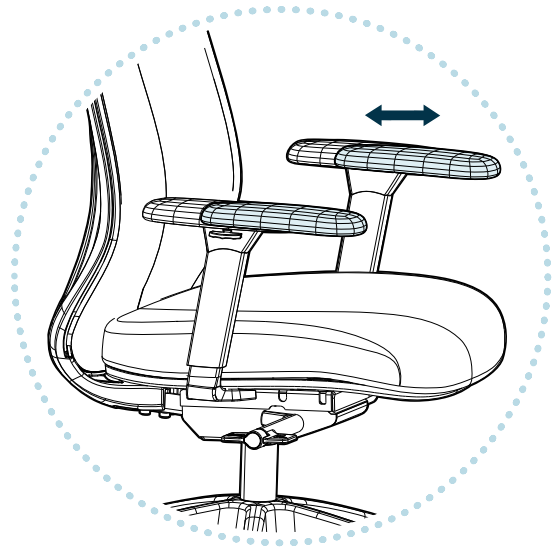

ARMREST POSITION ADJUSTMENT

To adjust the front-to-back position of the armrest, gently grab the center of the armrest, and slide forward or backward into the desired position.



ARMREST HEIGHT ADJUSTMENT

To adjust the arm height, press and hold button on the outside of the arms. Lift or lower the arms and release the button once at the desired height.



ARMREST ANGLE ADJUSTMENT

To adjust the angle of the armrest, gently grab the front or back of the armrest, and twist laterally into the desired position.

Adjustment Options

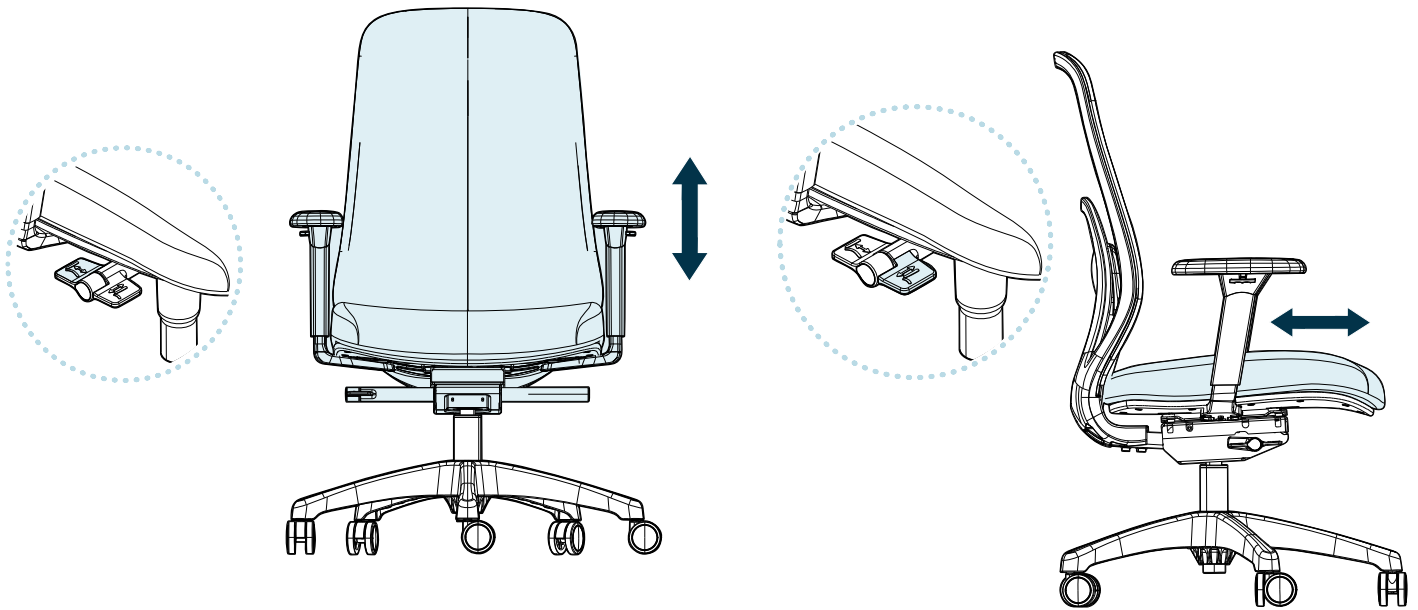

SEAT HEIGHT ADJUSTMENT

To adjust seat height, lift the back lever under the right side of the chair seat. Release the lever to lock the seat height in place.

SEAT DEPTH ADJUSTMENT

To adjust the seat depth, use the lever on the right side of the chair seat and pull the seat forward or push it back.

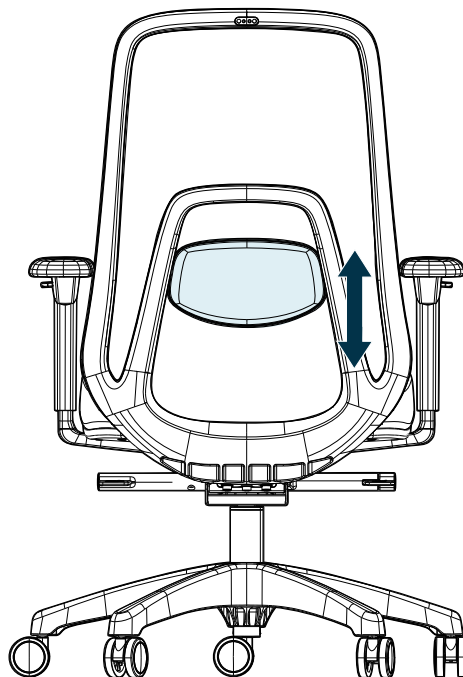

LUMBAR SUPPORT ADJUSTMENT

To adjust the lumbar support, slide it up or down until it is in the desired position.



WARNING: To prevent injuries and product failure, do not use this chair for standing, climbing, or leaning. Do not use if the chair is damaged or incorrectly assembled.



(800) 207-2587

vari.[®]