

QuickPro™ Table 48



No Tools
Required



2 People
Required



Holds up to
300 lb (136 kg)

vari®

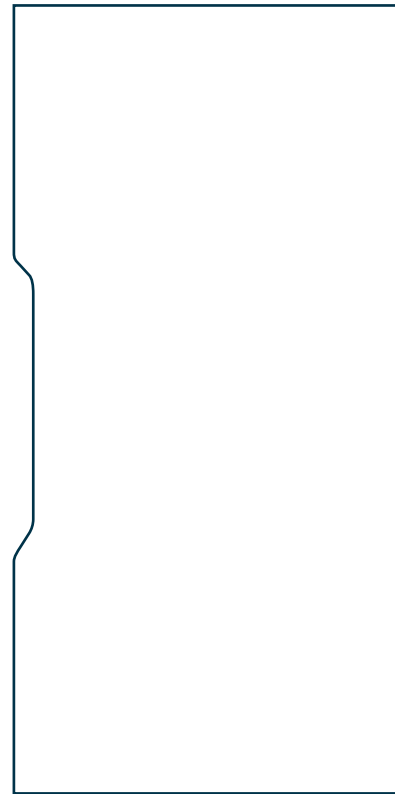

DESKTOP
x1



LEGS
x4

1

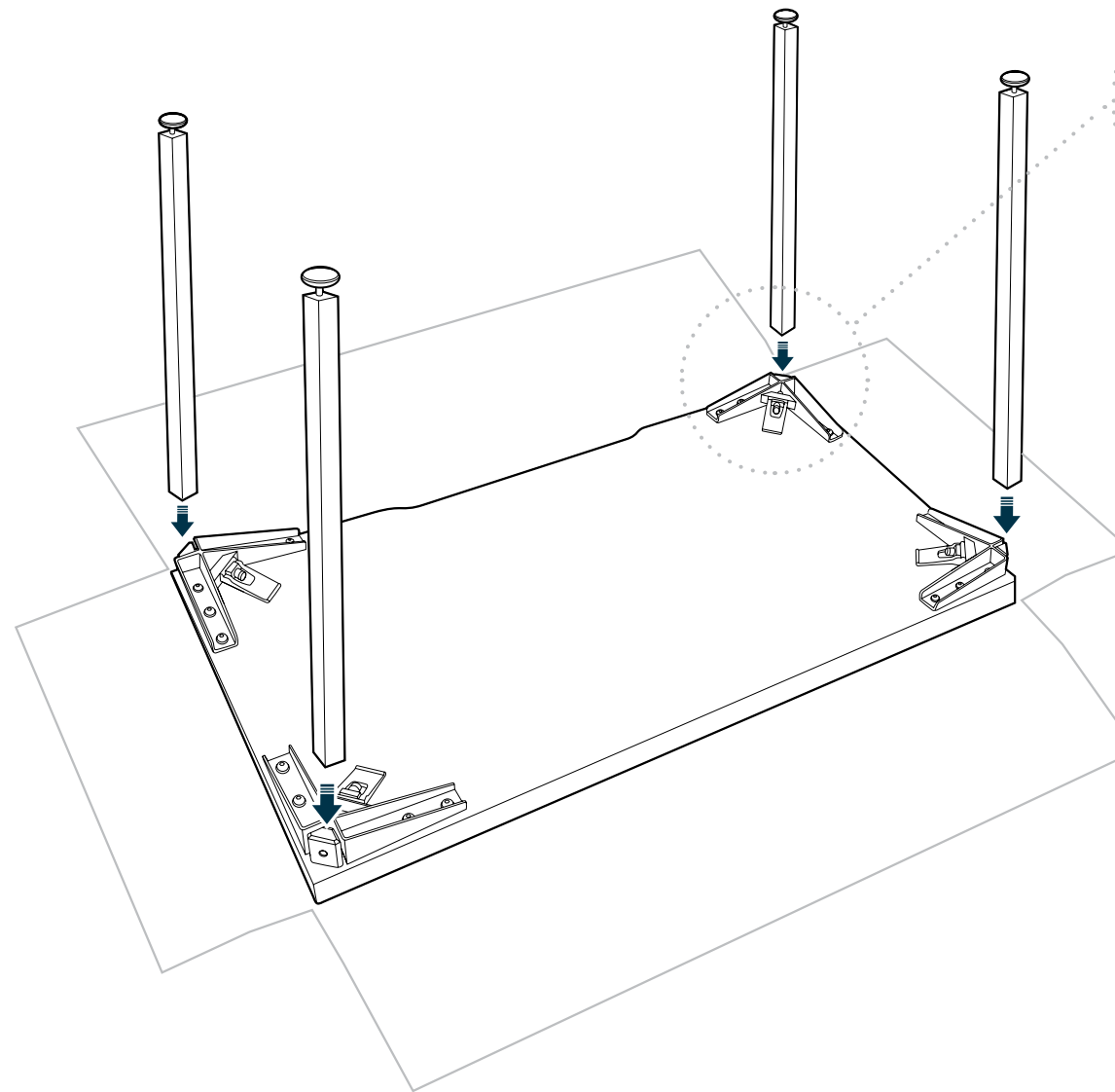

NOTE: We recommend assembling the QuickPro Table 48 with the desktop face down in the box to prevent any surface scratching.

Open the box, fold down all cardboard box flaps, and unpackage the legs.

2

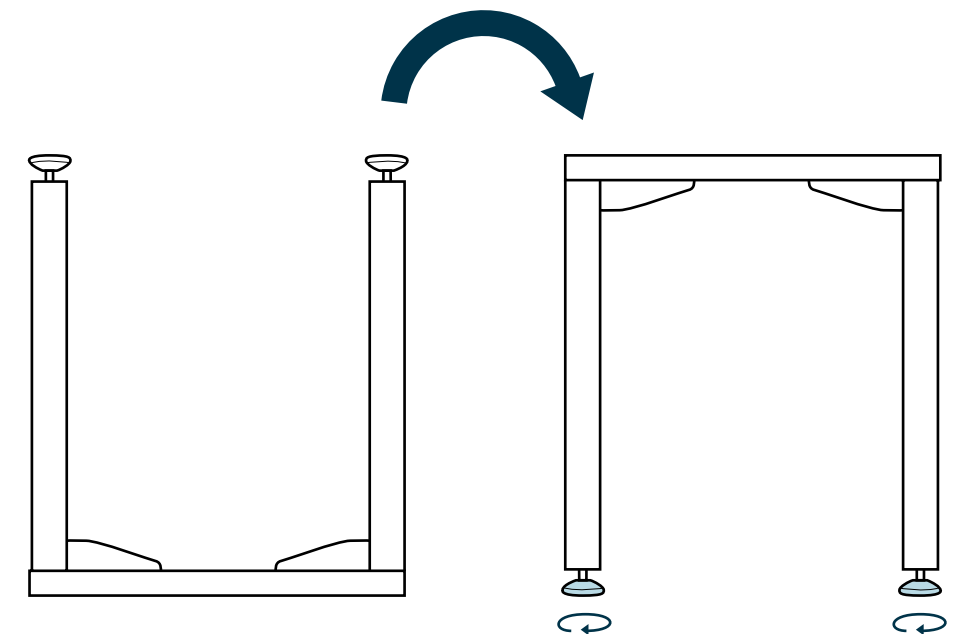
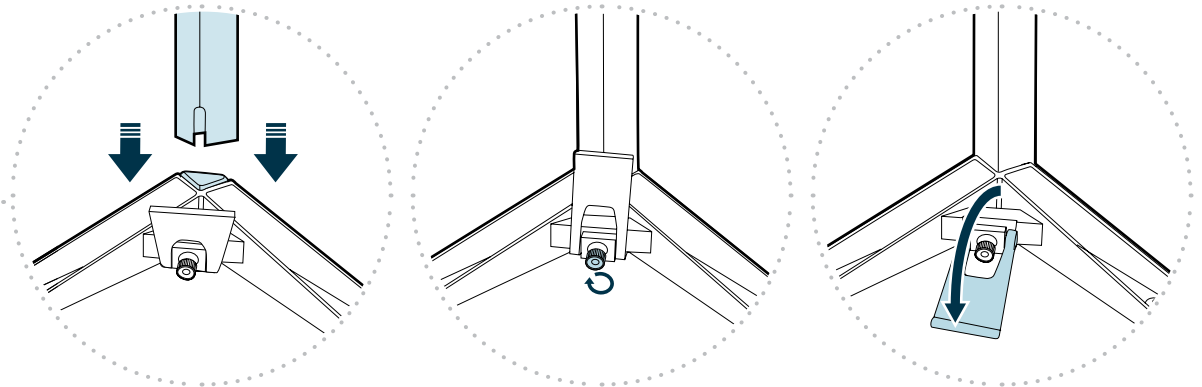

Slide a leg into a corner wedge, turn the bolt to tighten, and flip the handle down against the underside of the desktop to securely lock the leg in place. Repeat with the remaining legs.

With all four legs secured, and using two people, lift the table up, rotate it into an upright position, and set it down. Twist the footpads as needed to level the table.



(800) 207-2587