

LED Task Lamp + Wireless Charger



vari®

1 Unfold the lamp to standing and plug the power cord into the base, then plug the USB or AC adapter into an outlet.

2 To turn on, tap the power icon.
To adjust brightness, use the arrow icons.
To adjust light color, tap on the light icon to toggle through 4 color options.

3 To use the wireless charging function, place wireless charging compatible phone* onto the wireless charging pad on the lamp base. When the indicator light turns on, the phone is charging. When the phone is removed, the light will turn off.

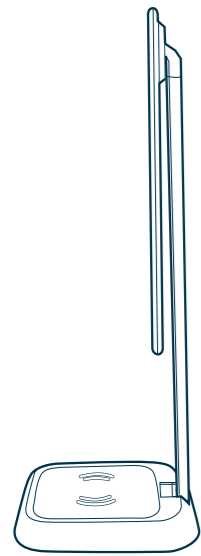

x1

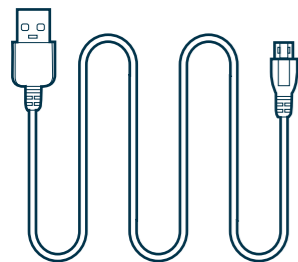
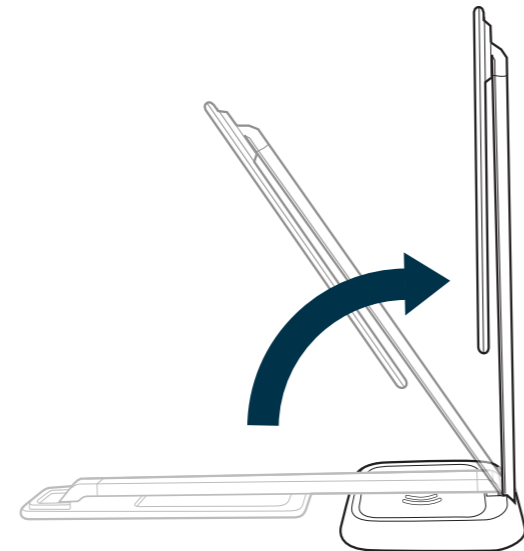

x1

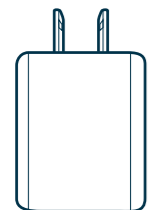
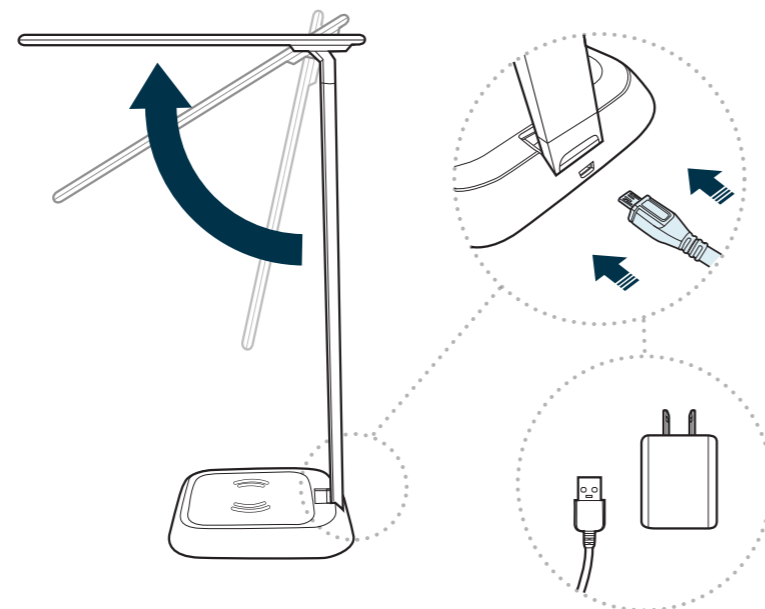

x1

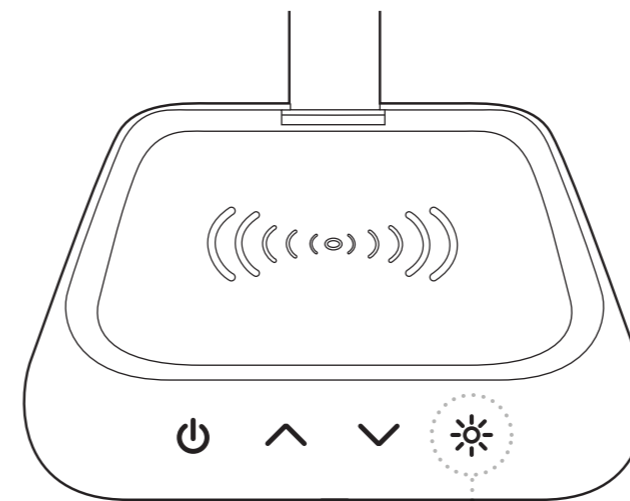

COLOR OPTIONS

- Natural White (4500K)
- Cool White (5600K)
- Warm White (2800K)
- Soft White (3400K)

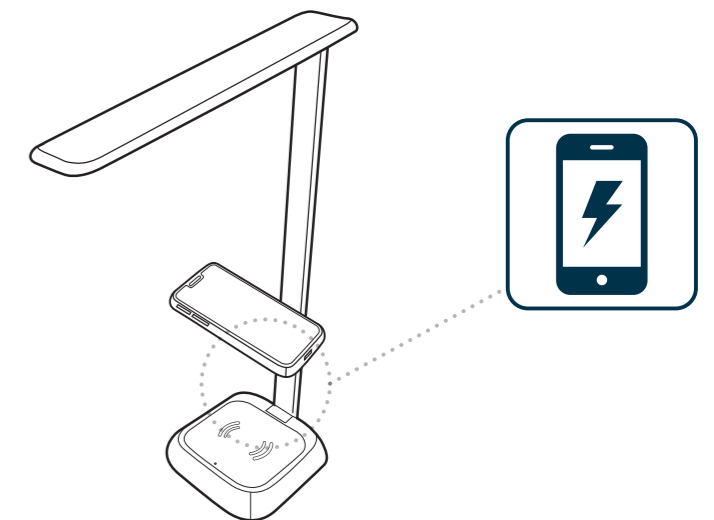

*Wireless charging compatible phone with built-in wireless charging receivers include, but aren't limited to:

- **iPhone** 8, 8 Plus, X, XS, XR, XS Max, 11, 11 Pro, 11 Pro Max
- **Samsung** S6, S6 Edge, S7, S8, S8+, S9, S9+, Note 8, Note 9
- **LG** V40 ThinQ, G7 ThinQ, V35 ThinQ
- **Google** Pixel 3, Pixel 3XL
- **Sony** X23, XZ2, 23V
- **Nokia** N5, N9, Nokia 1520



CAUTION: Do not use chemical solvents or harsh abrasives to clean as damage may occur.



WARNING: To reduce risk of fire, electric shock, or personal injury, do not install this lighting system in a wet location.



CAUTION: Keep lamp away from materials that may burn.



CAUTION: Do not stare directly into lamp light. This could be damaging to your eyes.

