

# Vari Tempur-Pedic Chair

vari®



2 People  
Recommended



Holds up to  
275 lb (124.74 kg)



# Components

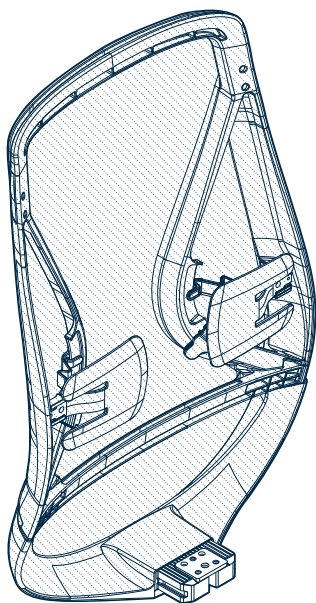

**x1**  
CHAIR BACK

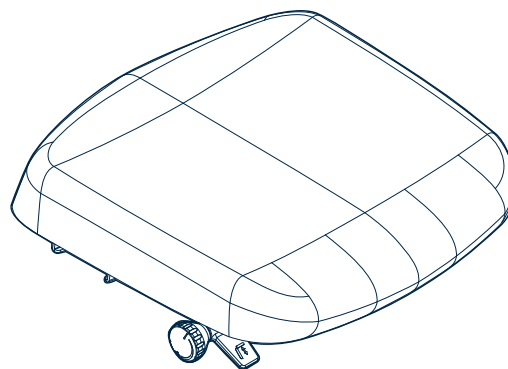

**x1**  
SEAT PAN

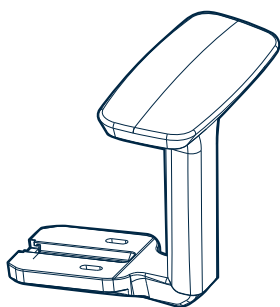

**x1**  
LEFT ARMREST

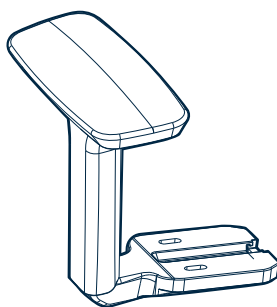

**x1**  
RIGHT ARMREST

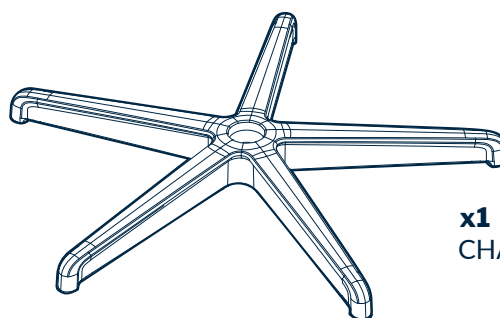

**x1**  
CHAIR BASE



**x1**  
M10 X 45MM  
HAND SCREW  
*Used to attach CHAIR BACK*

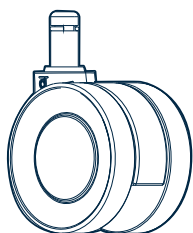

**x5**  
CASTERS



**x1**  
PISTON

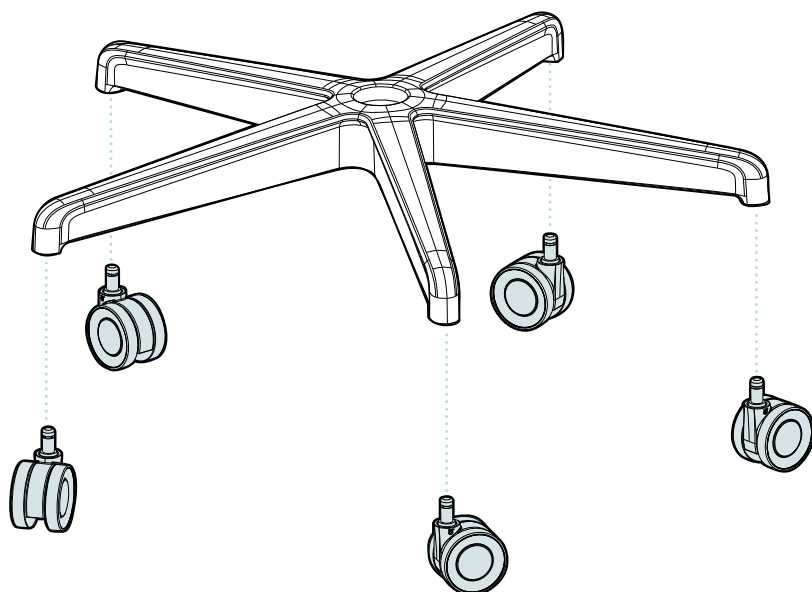

**x2**  
M10 X 45MM  
HAND SCREW  
*Used to attach ARMRESTS*

**1**

Insert the five **CASTERS** into the **CHAIR BASE** until they snap into place. Once attached, flip the base over.

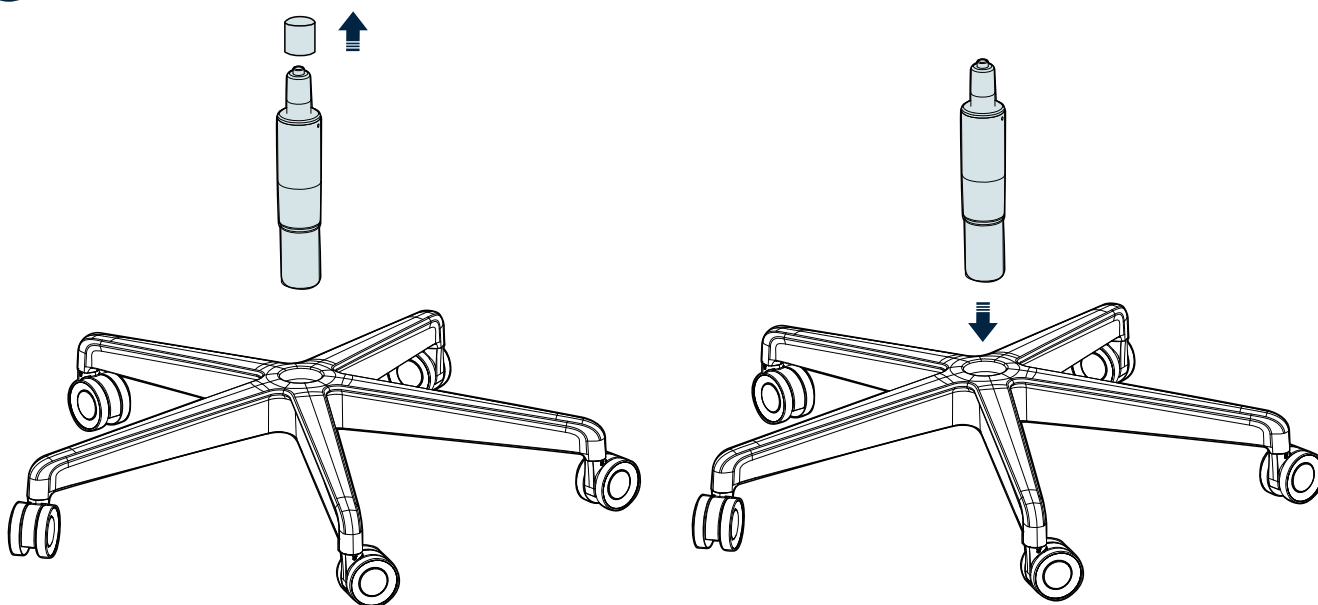
**2**

**NOTE:** Remove the **PROTECTIVE CAP** from the smaller end of the **PISTON**. Once the chair is assembled, the cap is no longer needed and can be discarded.

After removing the **CAP**, lower the larger end of the **PISTON** into the center of the base until it is secure.

3

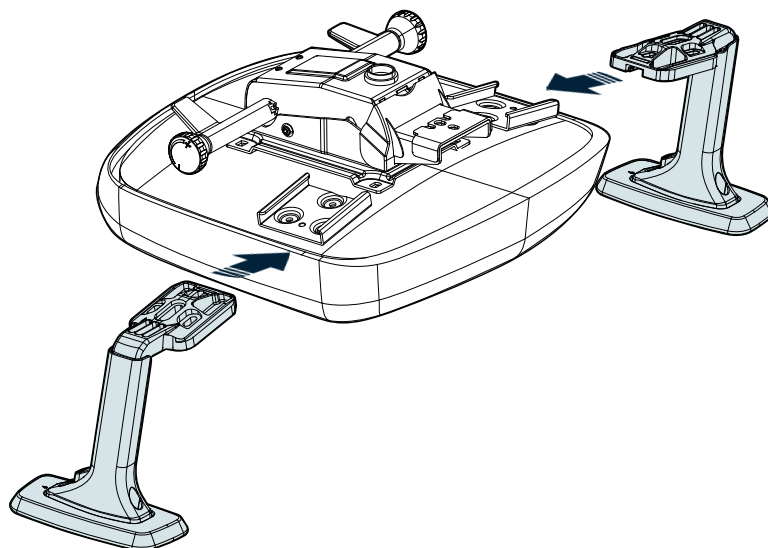

M10 X 45MM  
HAND SCREWS

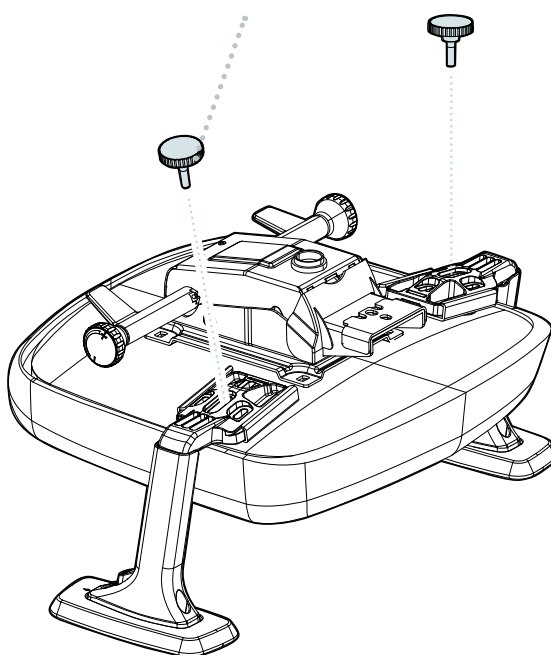

With the **SEAT PAN** upside down, align the **ARMREST** holes with the seat pan, ensuring the **L and R** marks match. Secure each armrest to the seat pan using **TWO (2) M10 X 45MM HAND SCREWS**. Ensure the **HAND SCREWS** match what is shown.

4

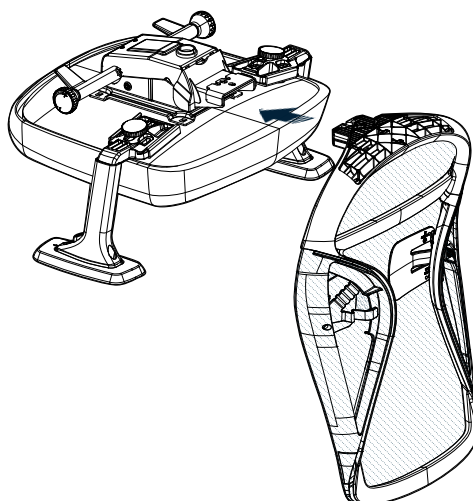

M10 X 45MM  
HAND SCREW

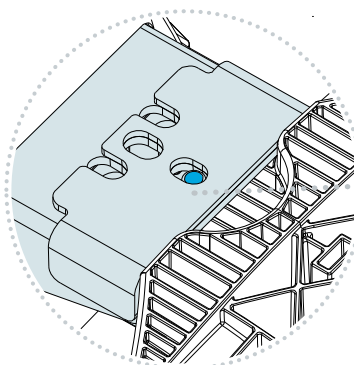
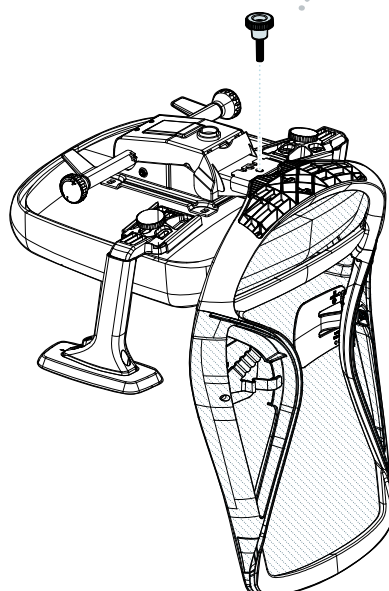

CLIP LOCK

Slide the **CHAIR BACK** onto the **SEAT PAN** and align the mounting hole. Push firmly into place until you hear a 'click' and see the clip lock into the hole, indicating it's properly secured. Secure the **CHAIR BACK** to the **SEAT PAN** using **ONE (1) M10 X 45MM HAND SCREW**. Ensure the **HAND SCREW** matches what is shown.

5

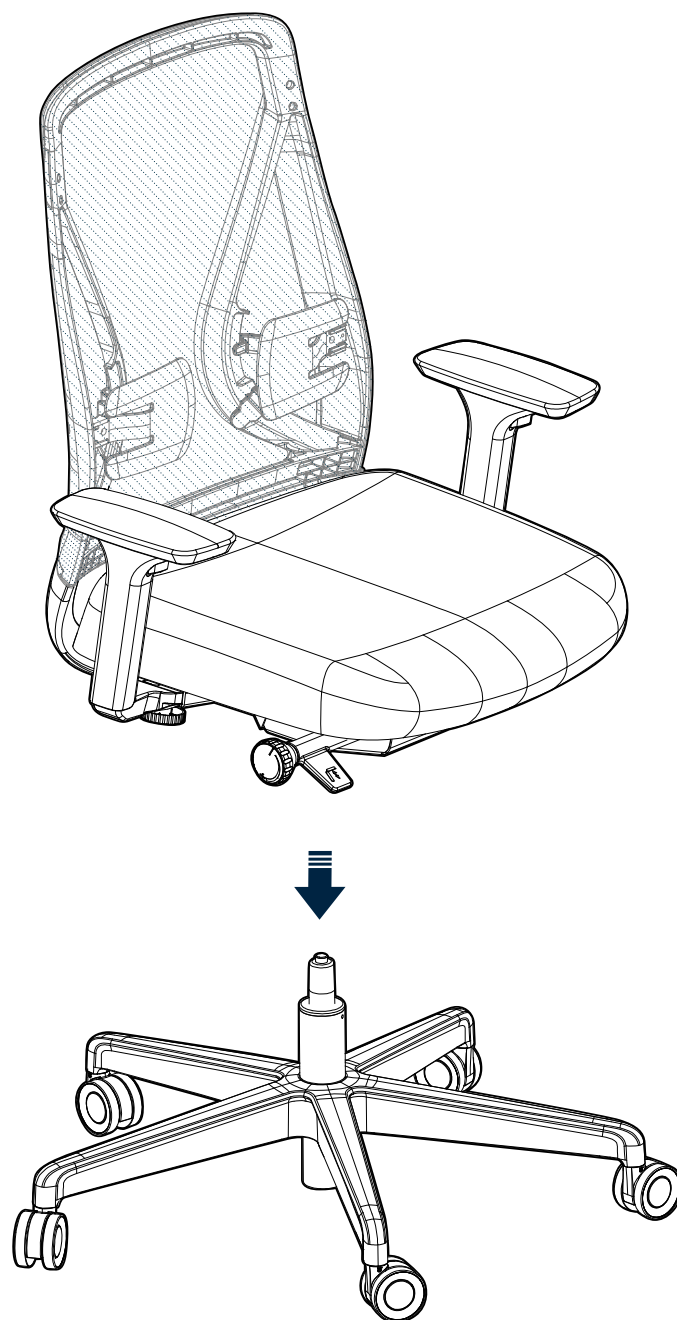

Lastly, take the assembled **CHAIR SEAT** and place it onto the **PISTON** that is attached to the **BASE**. Push down firmly to secure it in place.

**CAUTION:** Once assembled, do not attempt to disassemble the chair, as doing so could damage the product.

## Adjustment Options

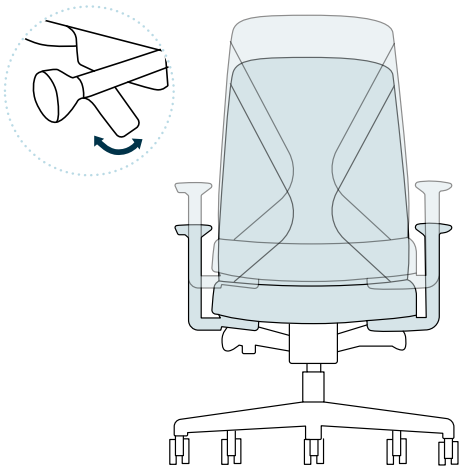

### SEAT HEIGHT ADJUSTMENT

To adjust the seat height, use the lever under the right side of the chair seat. Release the lever to lock the seat height in place.

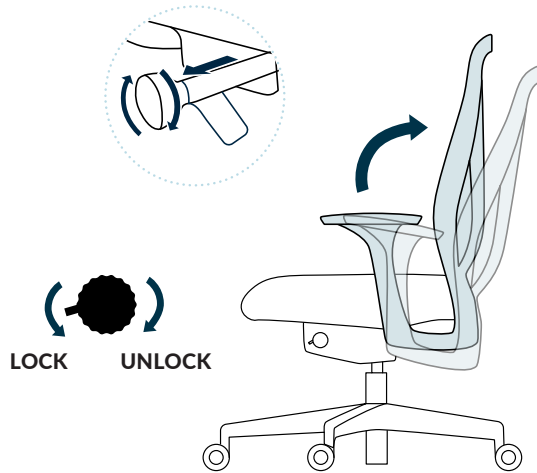

### CHAIR BACK TILT ADJUSTMENT

To allow the backrest to recline, turn the knob on the left side to the unlocked position. To prevent the backrest from reclining, turn the knob to the locked position.

To adjust how easily the backrest reclines, turn the knob on the right side forward to increase the tension or backward to decrease the tension.

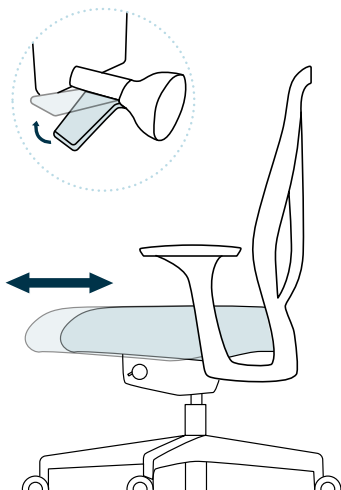

### SEAT DEPTH ADJUSTMENT

To adjust the seat depth, use the lever on the left and pull the seat forward or push it back.

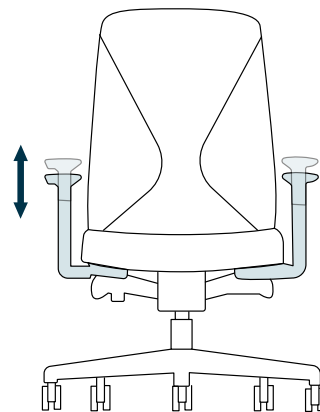

### ARMREST HEIGHT ADJUSTMENT

To adjust the arm height, press the button under the armrest and pull up or push down on the armrest.

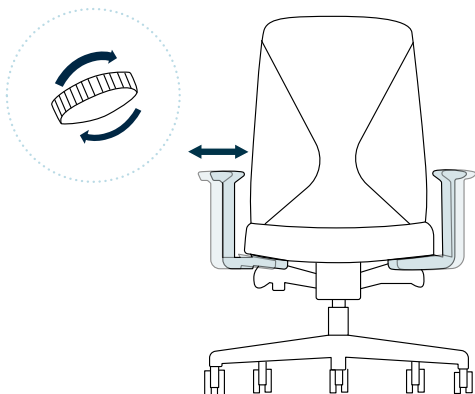

### ARMREST WIDTH ADJUSTMENT

Loosen the hand screw under each armrest, adjust them inward or outward, and then tighten the hand screws to lock each armrest in place.

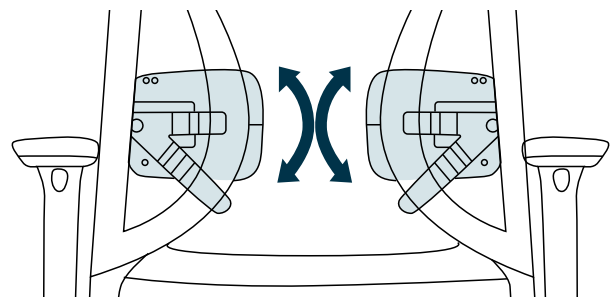

### LUMBAR SUPPORT STRENGTH ADJUSTMENT

To adjust the lumbar support on each side of the chair, manually move them up or down until they are in the desired position.



**WARNING:** To prevent injuries and product failure, do not use this chair for standing, climbing, or leaning. Do not use if the chair is damaged or incorrectly assembled.



(800) 207-2587

**vari**®