

# VariDesk® Pro Plus™ 36 Electric



Assembles in  
Minutes



Holds up to  
44 lb (19.9 kg)

**vari.**®

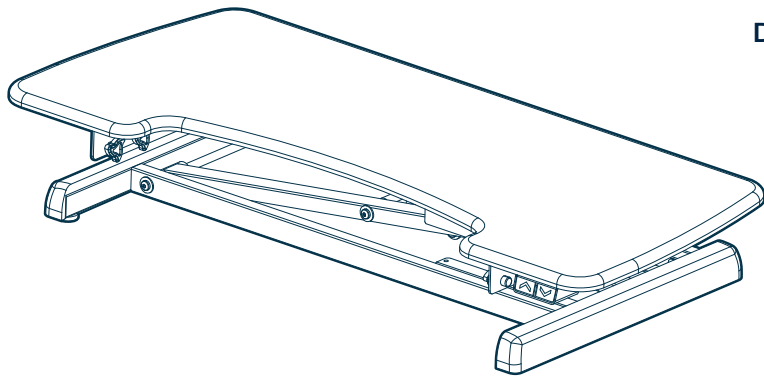

DESKTOP CONVERTER  
x1

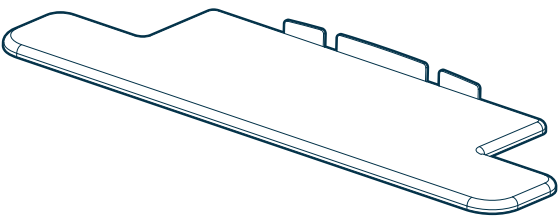

KEYBOARD TRAY  
x1



KEYBOARD TRAY  
BRACKETS  
x2



M5x12 COUNTERSUNK PHILLIPS HEAD  
MACHINE SCREW  
x6

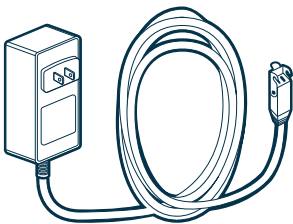

POWER ADAPTER  
AND CABLE  
x1

1

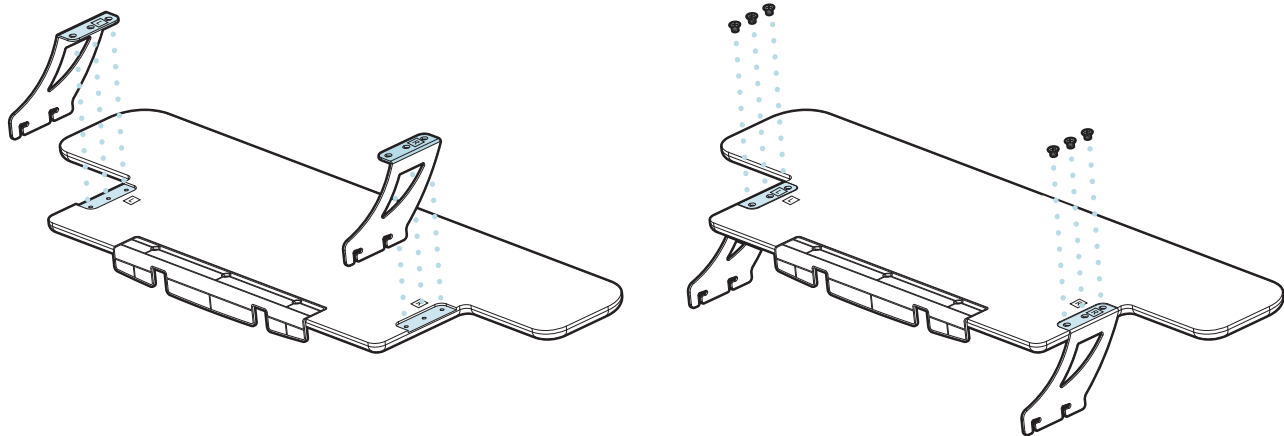
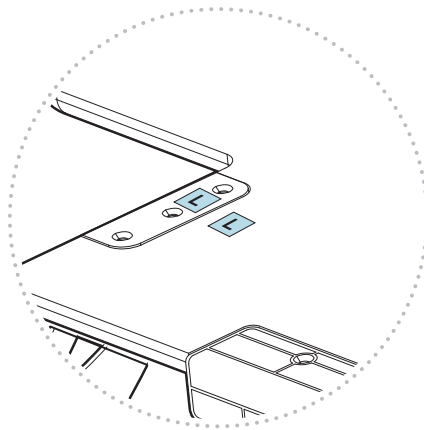
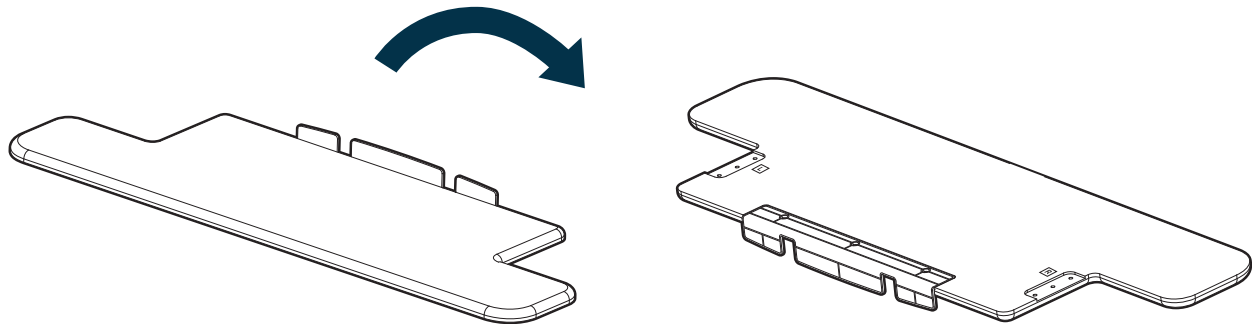

## Tools Needed (Not Included)

· PHILLIPS HEAD SCREWDRIVER

Remove all items from the box. Locate the keyboard tray from the box and turn it over. The bottom of the tray and the keyboard tray brackets will be marked with L and R stickers. Align each bracket with its corresponding countersunk holes, then attach the brackets to the tray with a Phillips head screwdriver and the 6 provided screws.

2

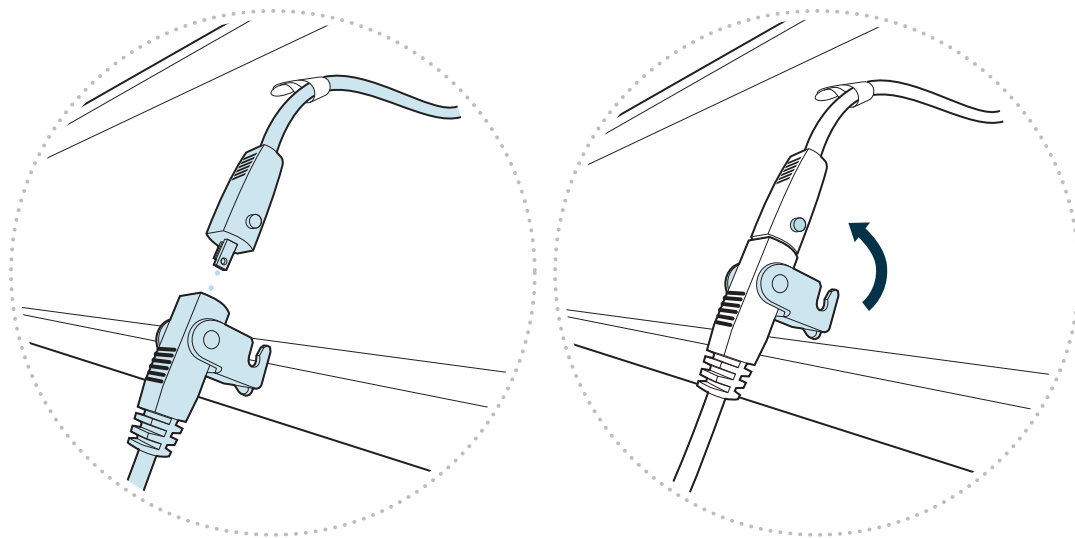

Locate the pre-installed power cord underneath the back of the converter's top tray. Join the power adapter cable to the pre-installed power cord, then secure the connection by latching the hook. Plug the converter into an outlet.

3

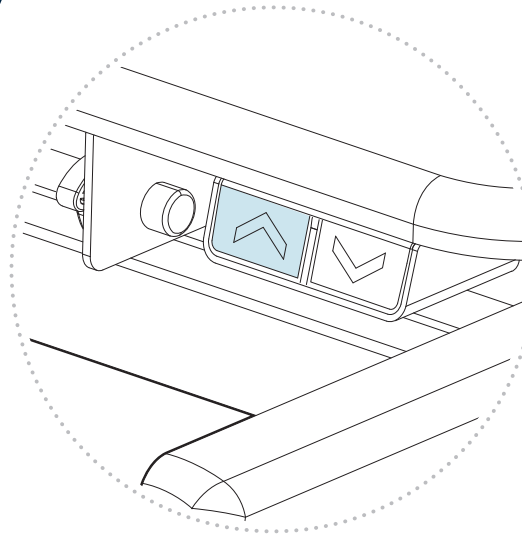

With the converter plugged in, press the up arrow button until the converter is raised to its highest position, providing room to attach the keyboard tray.

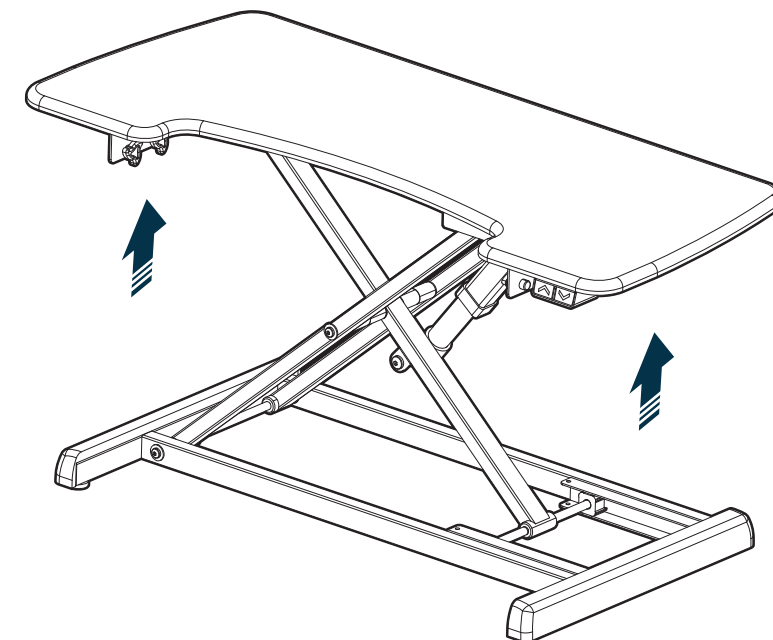

4

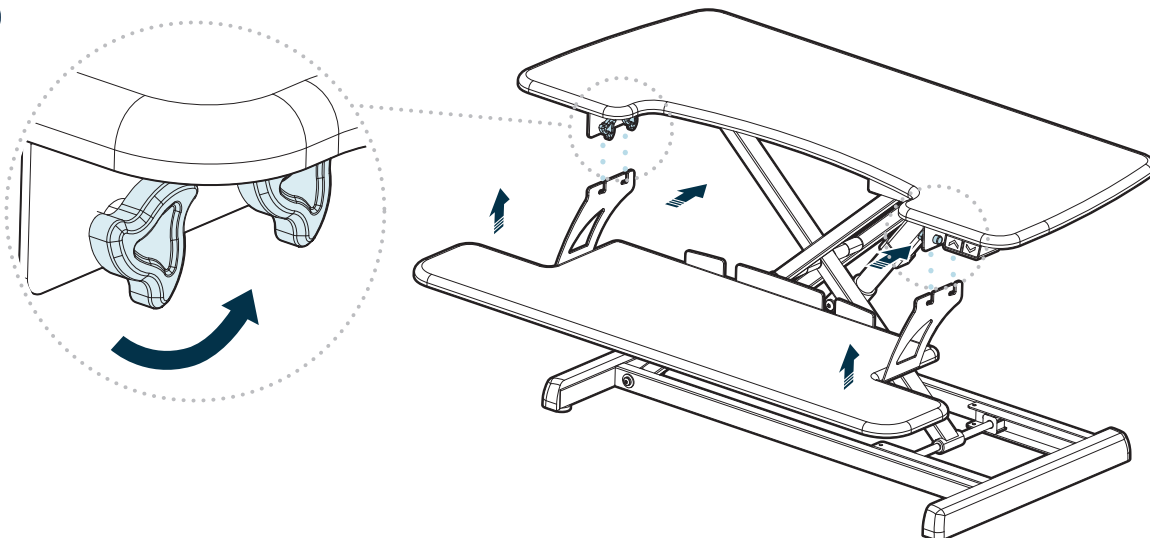

Locate the 4 pre-installed handscrews below the top tier. Loosen each of the handscrews, using one hand to hold one end still while turning the other end, until the post in between ends is accessible. Align the notches on the keyboard tray brackets with the handscrew posts, then slide the keyboard tray into place in an up-and-back motion. Tighten each of the handscrews to secure the tray in place.

5

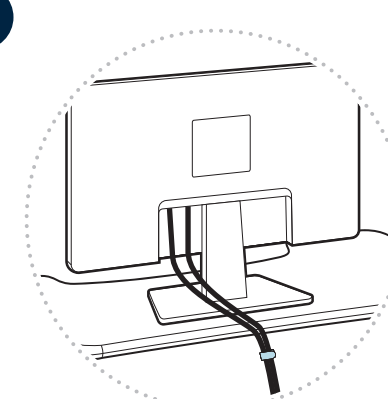
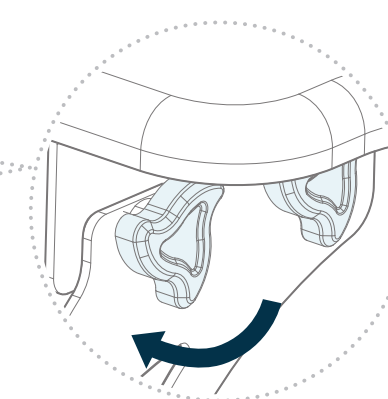
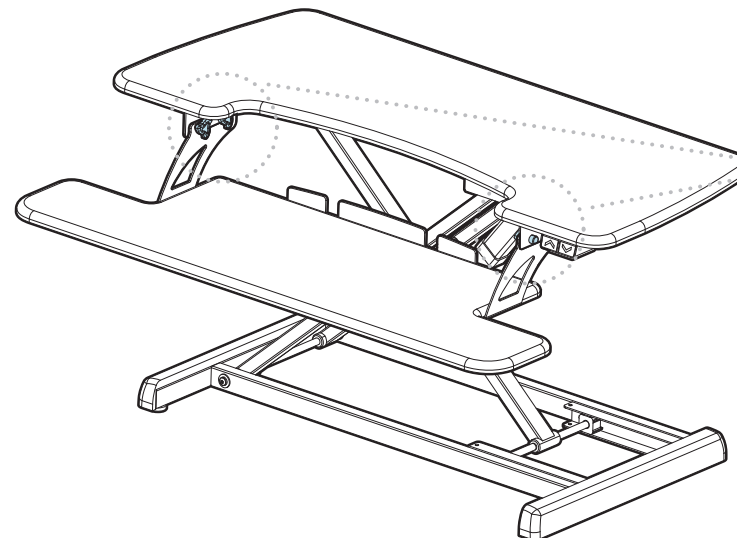

The included velcro straps can be used to neatly gather your cables and cords.



**WARNING:** Do not open any of the components, there is a danger of electric shock.



**WARNING:** Keep plug away from heated surfaces.



**WARNING:** Never operate this product if it has a damaged cord or plug, is not working properly, has been dropped or damaged, or was dropped into water. Contact our customer service department during business hours to report any issues.



**WARNING:** The Pro Plus™ 36 Electric is not intended for use by young children or for those persons who require supervision.



**WARNING:** To reduce risk of fire, electric shock, or personal injury, use only indoors and do not install in a wet or damp location.



**CAUTION:** Beverages such as water or coffee could cause product failure if spilled.



**WARNING:** Risk of finger injury - pinching hazard. Use caution when lowering desk.

#### Supplier's Declaration of Conformity 47 CFR § 2.1077 Compliance Information

Unique Identifier: 402932

Responsible Party - U.S. Contact Information

Varidesk, LLC  
450 Freeport Parkway  
Coppell, TX 75019  
1-800-207-2587

#### FCC Compliance Statement

This device complies with Part 15 of the FCC Rules. Operation is subject to the following two conditions: (1) This device may not cause harmful interference, and (2) this device must accept any interference received, including interference that may cause undesired operation.

