

PC Desk Mount

vari[®]



TOOLS NEEDED

- Phillips Head Screwdriver (not included)
- Power Drill with a Phillips Head Drill Bit (not included)



WEIGHT CAPACITY

35 lbs (15.87 kg)

TOP FRAME (A)
x1

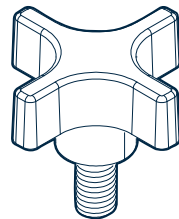
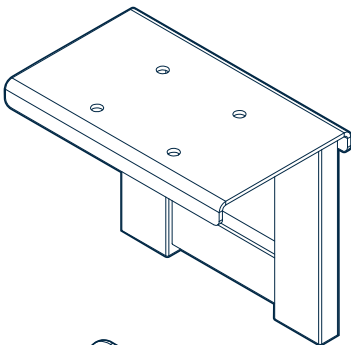

M8 X 15MM HAND
SCREW (E)
x2

BASE FRAME (B)
x1

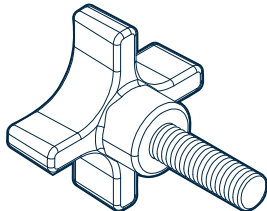
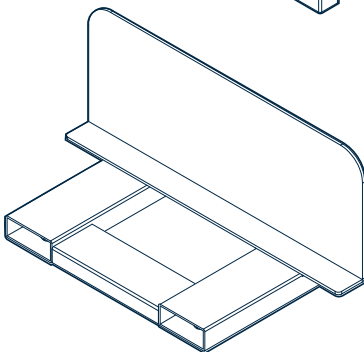

M8 X 25MM HAND
SCREW (F)
x2

SIDE FRAME (C)
x1

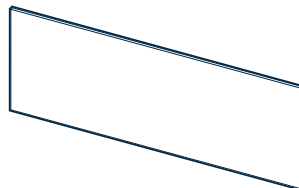
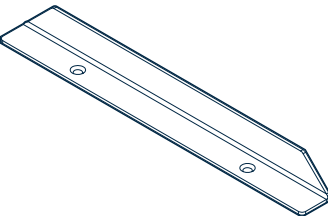

FOAM PAD (G)
x1

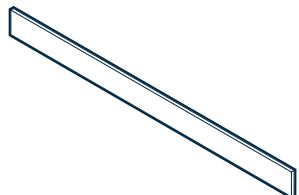

FOAM PAD (H)
x3

FRAME POSTS (D)
x2

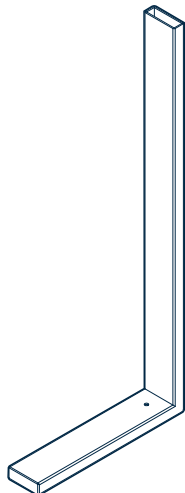

5/32 X 12MM
SCREW (I)
x2



M5 X 15MM
TAPPING SCREW (J)
x4

 (800) 207-2587

1

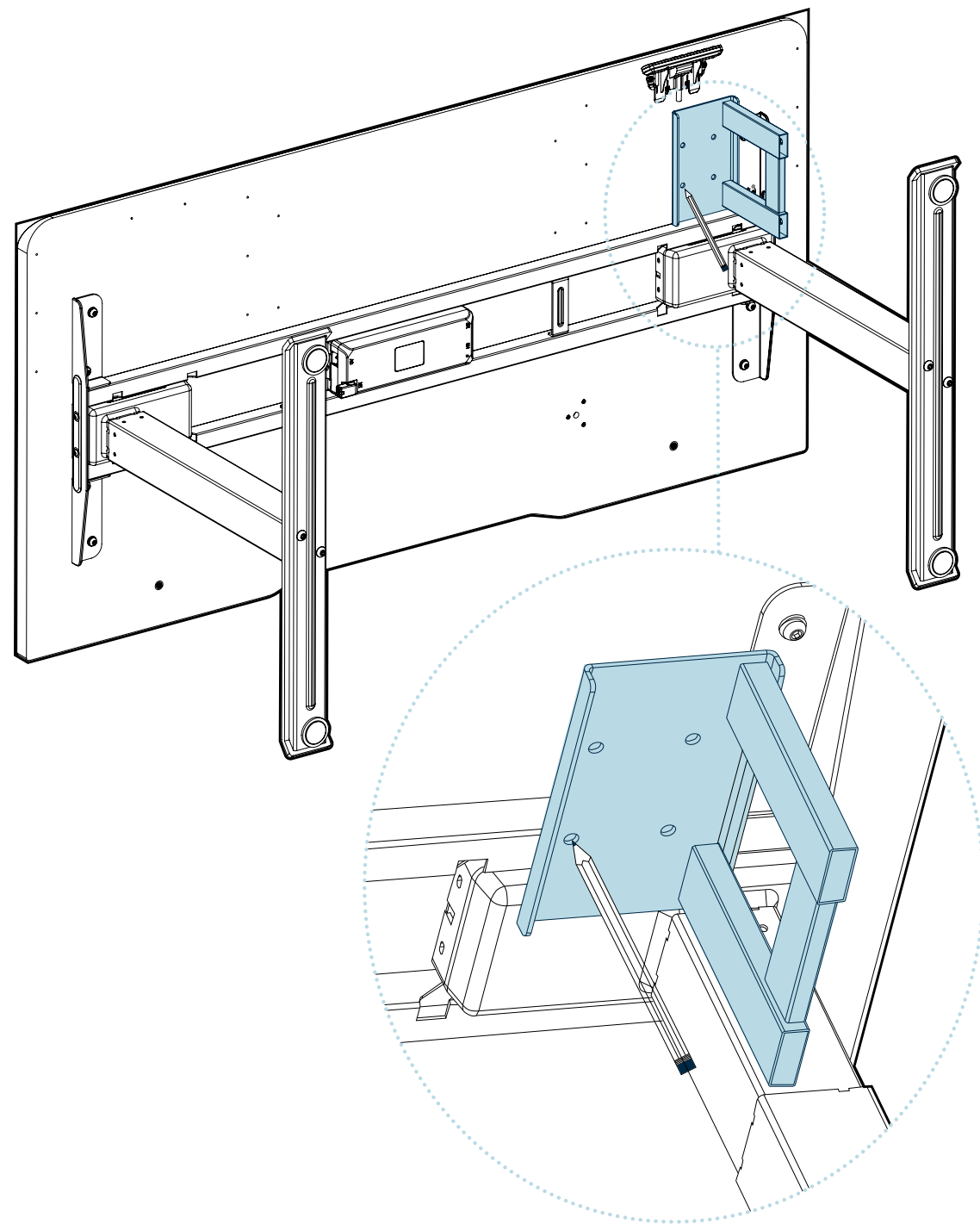

STEP 1: Confirm Installation Position and Pre-Drill Holes Before Assembly:

IMPORTANT: Before installation, check for any obstructions under the worksurface. This product is optimized for Vari® Electric Standing Desks and Tables that have a minimum depth of 26". If installing on a non-Vari product, ensure the desktop is at least 20mm (0.78") thick to prevent over-drilling.

Place the **TOP FRAME (A)** in your desired mounting position. Mark the screw hole locations on the underside of the worksurface.

Remove the **TOP FRAME (A)**. Use a drill (not included) with a 1/8" (3.2 mm) bit to make your pilot holes, no deeper than 1/2".

NOTE: Measure 1/2" (12.7 mm) from the tip of your drill bit, then place a piece of tape at this mark or use a marker to ensure that you don't drill too far.

2

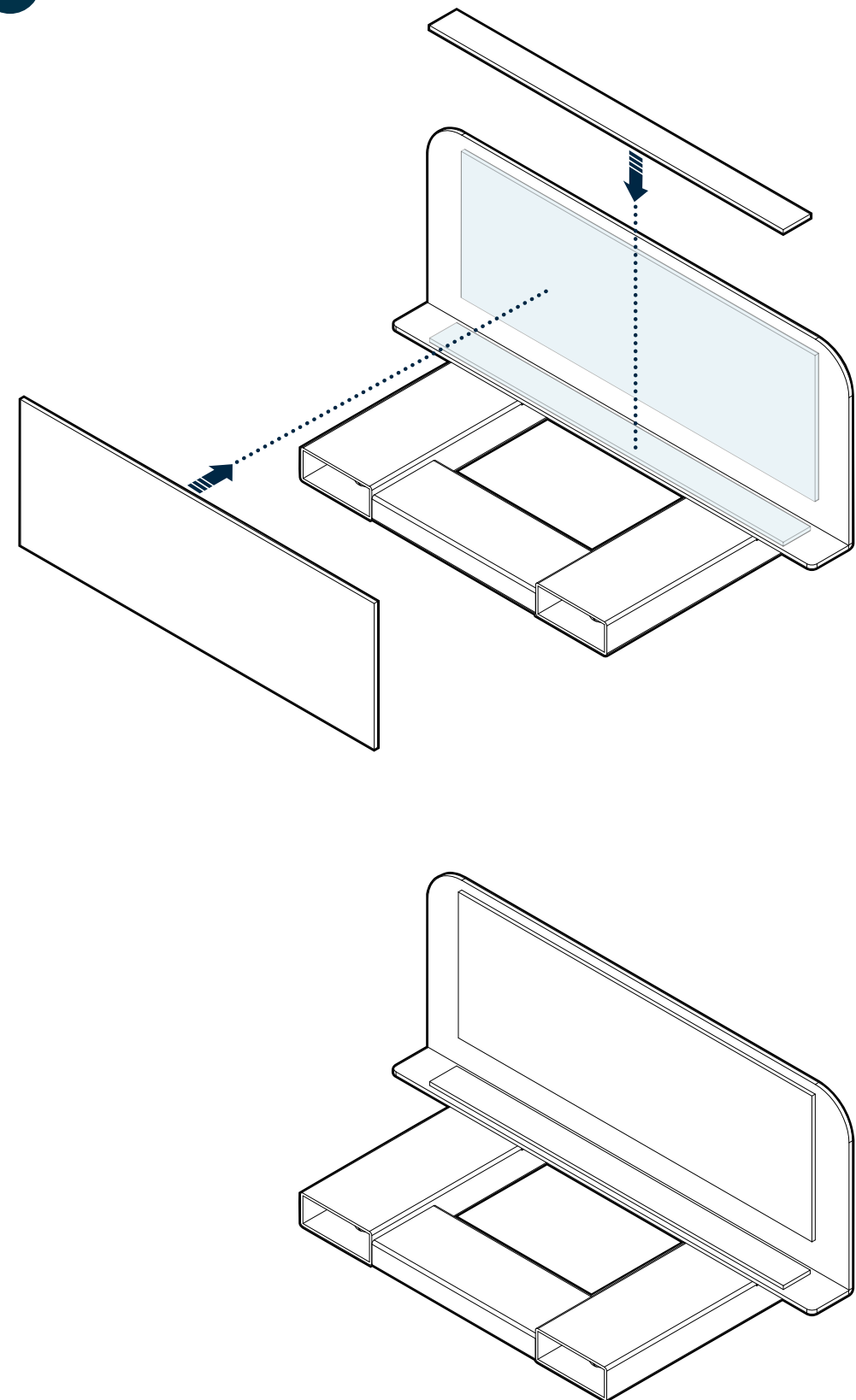

STEP 2: Prepare the Base Frame

Take the **BASE FRAME (B)** and attach one adhesive **FOAM PAD (H)** to the frame. Press firmly to secure it in place.

Attach another adhesive **FOAM PAD (G)** to the side of the **BASE FRAME (B)**. Press firmly to secure it.

3

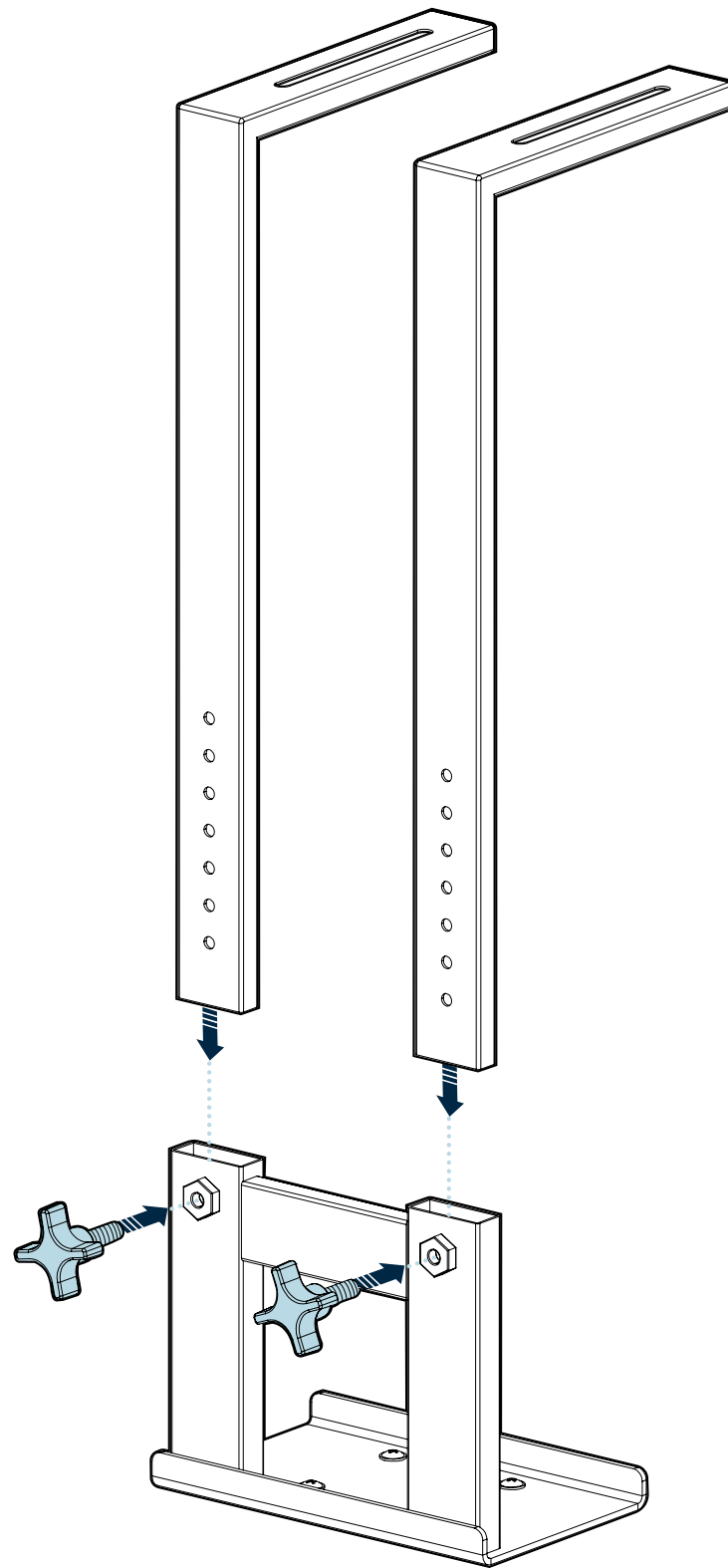

STEP 3: Adjust for Your Computer Tower

Measure the height of your computer tower (CPU) to ensure the **FRAME POSTS (D)** can accommodate it.

Insert both **FRAME POSTS (D)** into the **TOP FRAME (A)**.

Adjust the height of the **FRAME POSTS (D)** to fit your CPU, aligning the holes on the posts with the threaded holes on the **TOP FRAME (A)**.

Secure the posts in place with two **HAND SCREWS (F)** by turning them until they firmly contact the frame posts.

4

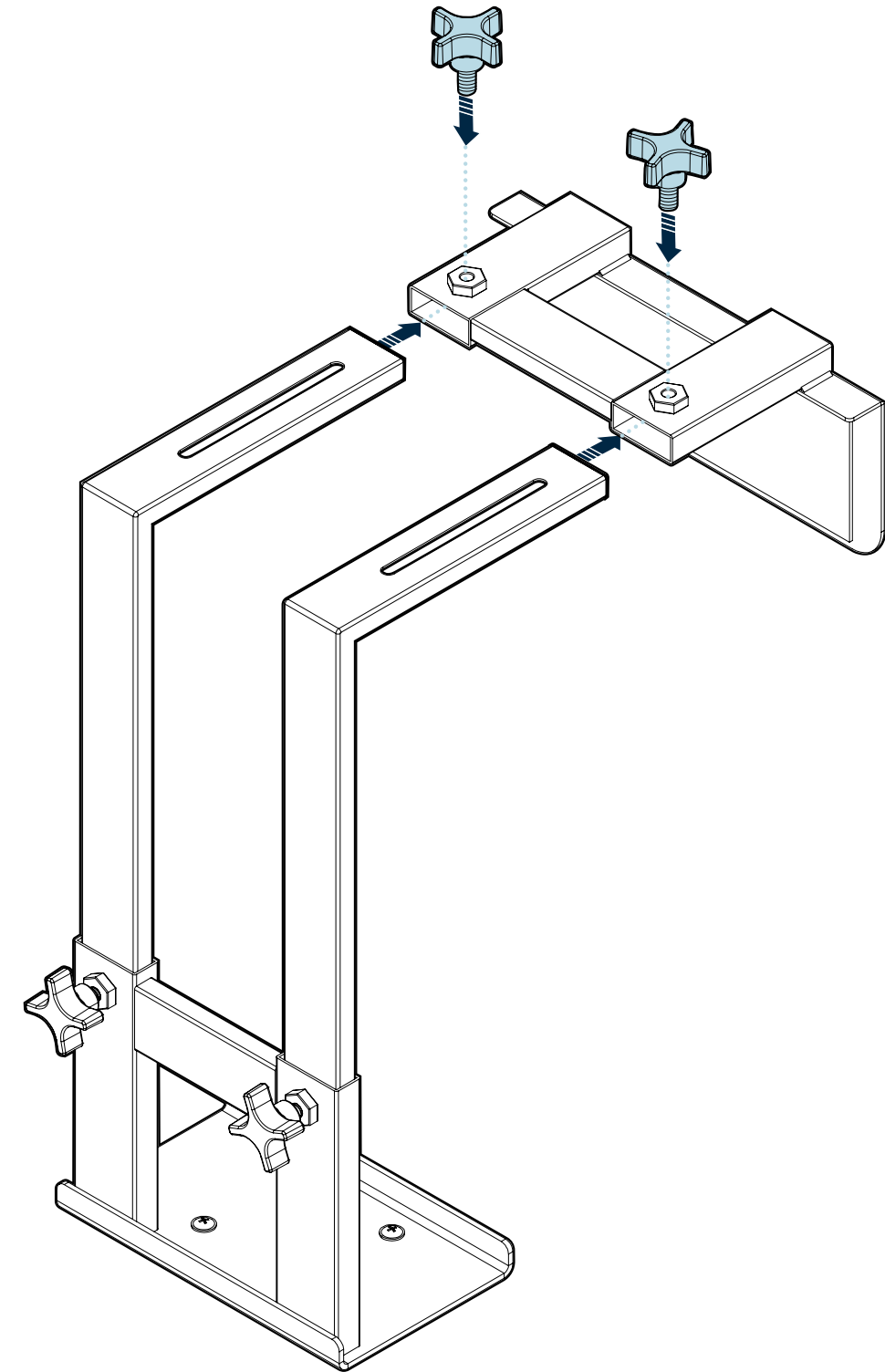

STEP 4: Attach the Base Frame

Slide the **BASE FRAME (B)** into the tubes of the **FRAME POSTS (D)**.

Keep the hand screws slightly loose for easy adjustments. Tighten them fully once the CPU is in place.

5

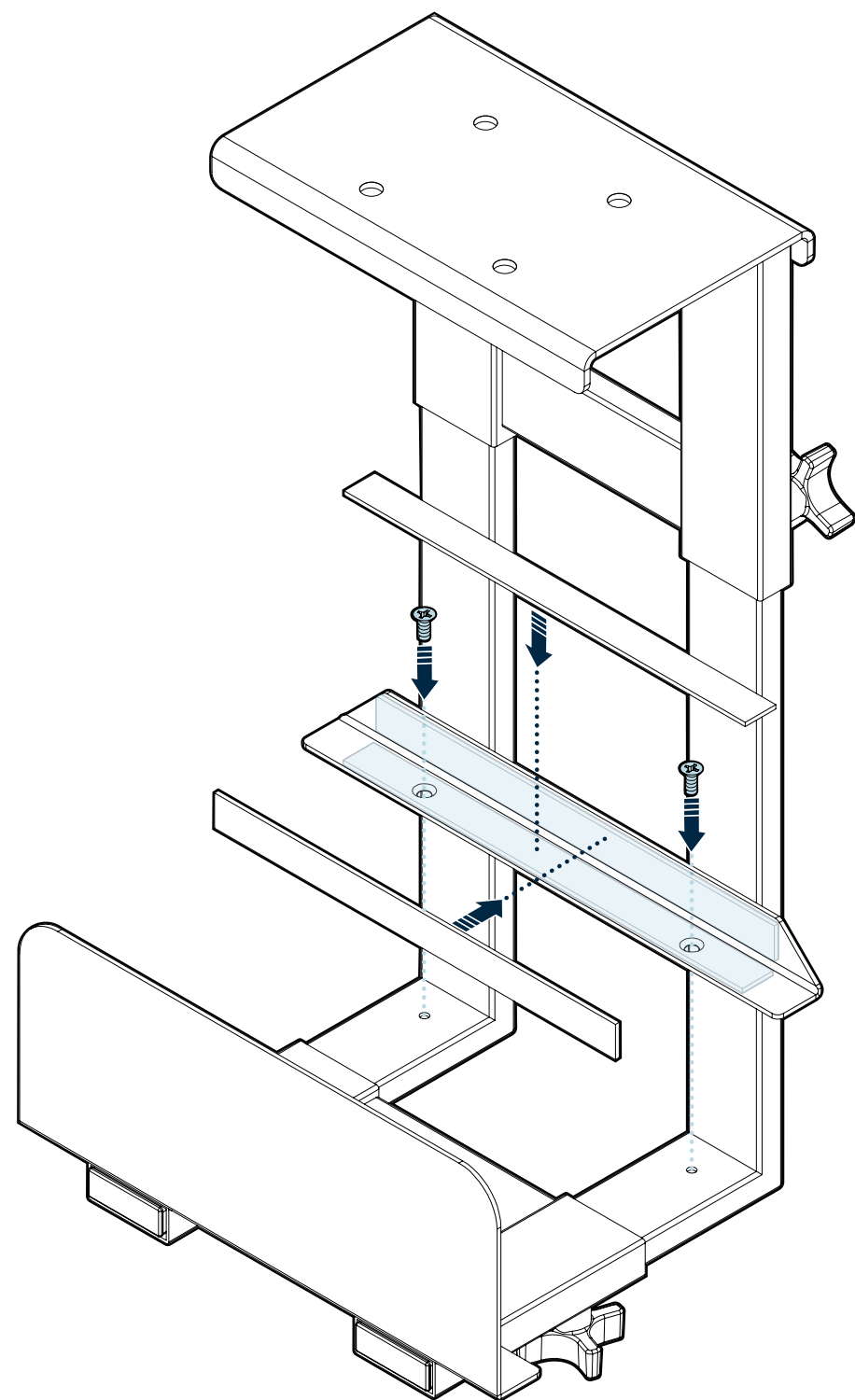

STEP 5: Install the Side Frame

Align the screw holes of the **SIDE FRAME (C)** with the holes on the **FRAME POSTS (D)**. Insert two **5/32 X 12MM SCREWS** and tighten securely using a Phillips Head Screwdriver (not included).

Adhere two adhesive **FOAM PADS (H)** to the **SIDE FRAME (C)**.

6

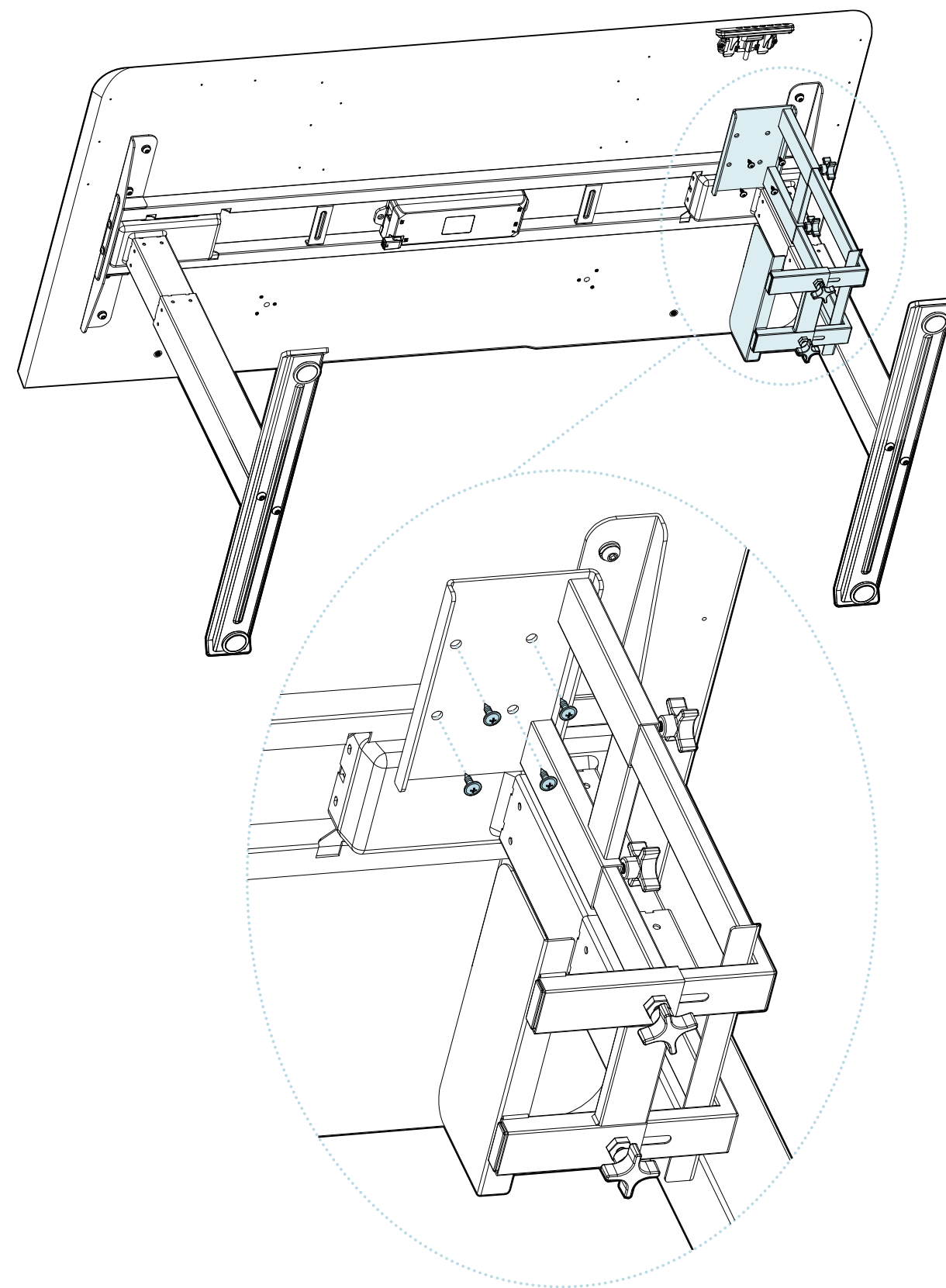

STEP 6: Mount Under the Desk

IMPORTANT: Before installation, check for any obstructions under the desktop. This product is optimized for Vari® Electric Standing Desks and Tables that have a minimum depth of 26".

Align the **TOP FRAME (A)** with the holes you pre-drilled during Step 1. Using a Phillips Head Screwdriver or Power Drill with a Phillips Head Drill Bit, insert and securely tighten four **M5 x 15mm TAPPING SCREWS (J)**.

Place your CPU in the PC Desk Mount and adjust the frame width and height by loosening or tightening the hand screws to securely hold the CPU in place.